

APPLICATION FOR A MODIFICATION ORDER

Wildlife and Countryside Act 1981
**The Definitive Map and Statement of Public Rights of Way
 in Bath and North East Somerset**

To : *Public Rights of Way, Bath and North East Somerset Council*
 of : *Lewis House, Manvers Street, Bath, BA1 1JG*
 I/we : Mrs. L. Daly, Clerk to Bathampton Parish Council
 of : 67 69 Holcombe Close, Bathampton, Bath, BA2 6UP

*name and
address of
applicant(s)*

hereby apply for an order under section 53(2) of the Wildlife and Countryside Act 1981
 modifying the Definitive Map and Statement for the area by;

N.B. CHOOSE ONE OR MORE OF THE FOUR OPTIONS GIVEN BELOW

* adding the	*footpath	from #	East of Candy Bridge on Meadow Lane ----- ST769661	to #	The Kennet & Avon Canal Towpath ----- ST769662
--------------	-----------	--------	--	------	---

** delete as
appropriate*

*upgrading/downgrading the route currently shown as a	*footpath *bridleway *restricted byway *byway open to all traffic	from#	-----	to #	-----
to be shown as a	*footpath *bridleway *restricted byway *byway open to all traffic	-----	-----	-----	-----

*# fill in grid
references
for start
and end of
routes*

* deleting the	*footpath *bridleway	from#	-----	to #	-----
* varying /adding to the particulars relating to the	*footpath *bridleway *restricted byway *byway open to all traffic	from #	-----	to #	-----

by providing that

*explain how
you want
the
particulars
altered*

and shown on the map accompanying this application.

I/we attach copies of the following evidence in support of this application;

*list the
evidence
which
supports
your
application*

User evidence forms demonstrating un-impeding use of this footpath by ~~20~~³⁰ people over a
 20-year period

Dated 21 January 2022

Signed



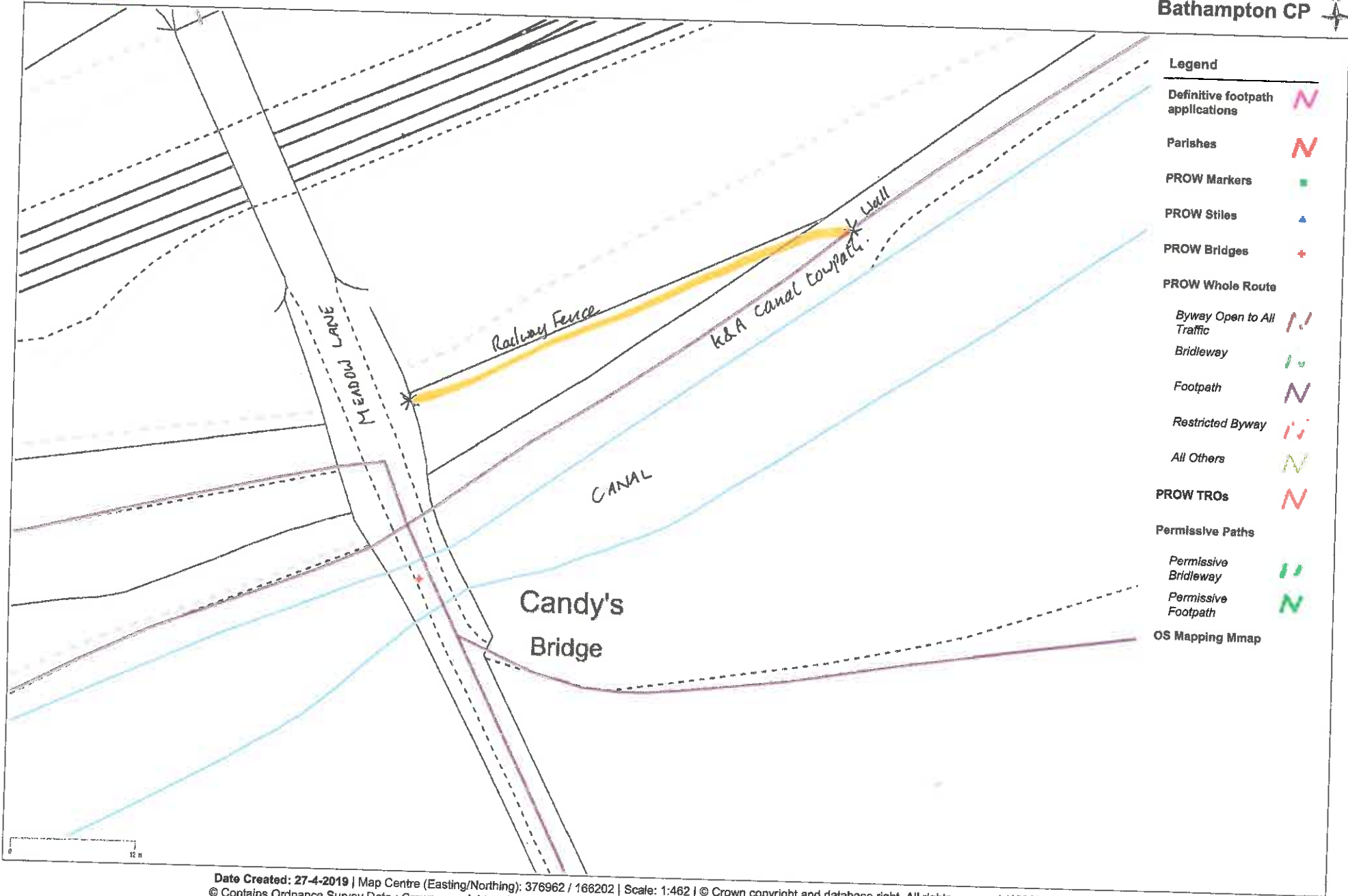

**CERTIFICATE OF SERVICE OF NOTICE
OF
APPLICATION FOR A MODIFICATION ORDER**

Wildlife and Countryside Act 1981
**The Definitive Map and Statement of Public Rights of Way
in Bath and North East Somerset**

To : *Public Rights of Way, Bath and North East Somerset Council*
of : *Lewis House, Manvers Street, Bath, BA1 1JG*

I/we : *Mrs. L. Daly, Clerk to Bathampton Parish Council*
of : *67 69 Holcombe Close, Bathampton, Bath, BA2 6UP*

*name and
address of
applicant(s)*

hereby certify that the requirements of paragraph 2 of Schedule 14 to the Wildlife and Countryside Act 1981 have been complied with and attach a copy of each notice served pursuant to that Paragraph.

Dated 21st February 2022 Signed 

Paragraph 2 of Schedule 14 to the Wildlife and Countryside Act states that ;

“the applicant shall serve a notice stating that the application has been made on every owner and occupier of any land to which the application relates”

“if, after reasonable inquiry has been made, the authority are satisfied that it is not practicable to ascertain the name or address of an owner or occupier of any land to which the application relates the authority may direct that the notice ... may be served by addressing it to him by the description ‘owner’ or ‘occupier’ of the land (describing it) and by affixing it to some conspicuous object or objects on the land”

OF APPLICATION FOR A MODIFICATION ORDER

Section 53(5) and Schedule 14 to the Wildlife and Countryside Act 1981
**The Definitive Map and Statement of Public Rights of Way
 in Bath and North East Somerset**

To : Mr. J. Hill, Network Rail Community Relations Executive,
 of : Network Rail, 3rd Floor, Western House, 1 Holbrook Way Swindon
SN1 1BD

*name and
address of
owner or
occupier*

Notice is hereby given that on 21st day of February 2022
 the

*give the date
of your
application*

I/we : Mrs. L. Daley, Clerk to Bathampton Parish Council
 of : 67 69 Holcombe Close, Bathampton, Bath, BA2 6UP

*name and
address of
applicant(s)*

made application to the Public Rights of Way Team, Bath and North East Somerset
 Council, Lewis House, Manvers Street, Bath, BA1 1JG that the Definitive Map and
 Statement for the area be modified by;

N.B. CHOOSE ONE OR MORE OF THE FOUR OPTIONS GIVEN BELOW

*adding the *footpath from# Candy Bridge to # Kennet & Avon Canal
 on Meadow Lane, Bathampton ST769661 Towpath, Bathampton ST769662

** delete as
appropriate -
take detail
from
application*

*upgrading/downgrading the route currently shown as a *footpath from# to #
 *bridleway
 *restricted byway
 *byway open to all traffic
 to be shown as a *footpath
 *bridleway
 *restricted byway
 *byway open to all traffic

*deleting the *footpath from# to #
 *bridleway
 *restricted byway
 *byway open to all traffic

*varying /adding to the particulars relating to the *footpath from# to #
 *bridleway
 *restricted byway
 *byway open to all traffic

by providing that
 and shown on the map accompanying this notice.

*explain how
you want
the
particulars
altered*

Dated 21st February 2022 Signed 

69 Holcombe Close
Bathampton
Bath
BA2 6UP

21 February 2022

Mr J. Hill
Network Rail,
3rd Floor,
Western House,
1 Holbrook Way
Swindon SN1 1BD

Dear Mr Hill

Bathampton footpath: Application for registration of a public right of way

A public footpath extending from the Kennet and Avon Canal towpath, Bathampton to Candy Bridge on Meadow Lane, has been used by the local community for many years but remains unregistered. Bathampton Parish Council is now applying for a Definitive Map Modification Order to register this path as a public right of way before the 2026 deadline. Under the Countryside and Wildlife Act 1981, applicants are required to notify landowners; please find attached official notification of this application.

If you have any questions relating to the matter, please contact myself or Councillor David Beard, whose email address is David.Beard@uwe.ac.uk.

Yours sincerely,

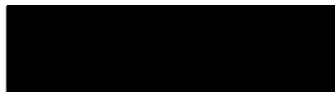

Mrs. L. Daly
Clerk to Bathampton Parish Council

NOTICE OF APPLICATION FOR A MODIFICATION ORDER

Section 53(5) and Schedule 14 to the Wildlife and Countryside Act 1981
**The Definitive Map and Statement of Public Rights of Way
 in Bath and North East Somerset**

To : Mr. M. Evans, Director Wales and South West
 of : National Waterways Museum Ellesmere Port, South Pier Road,
 Ellesmere Port, Cheshire, CH65 4FW

*name and
 address of
 owner or
 occupier*

Notice is hereby given that on 21st day of February 2022
 the

*give the date
 of your
 application*

I/we : Mrs. L. Daley, Clerk to Bathampton Parish Council
 of : 67 69 Holcombe Close, Bathampton, Bath, BA2 6UP

*name and
 address of
 applicant(s)*

made application to the Public Rights of Way Team, Bath and North East Somerset
 Council, Lewis House, Manvers Street, Bath, BA1 1JG that the Definitive Map and
 Statement for the area be modified by;

N.B. CHOOSE ONE OR MORE OF THE FOUR OPTIONS GIVEN BELOW

*adding the footpath from# Candy Bridge on Meadow Lane, Bathampton ST769661 to # Kennet & Avon Canal Towpath, Bathampton ST769662

** delete as
 appropriate -
 take detail
 from
 application*

*upgrading/downgrading the route currently shown as a footpath
bridleway
restricted byway
byway open to all traffic
 to be shown as a footpath
bridleway
restricted byway
byway open to all traffic

*deleting the footpath
bridleway
restricted byway
byway open to all traffic

*varying /adding to the particulars relating to the footpath
bridleway
restricted byway
byway open to all traffic

by providing that
 and shown on the map accompanying this notice.

*explain how
 you want
 the
 particulars
 altered*

Dated 21st February 2022 Signed 

69 Holcombe Close
Bathampton
Bath
BA2 6UP

21 February 2022

Mr M. Evans
Director, Wales and South West,
National Waterways Museum,
Ellesmere Port,
South Pier Road,
Ellesmere Port,
Cheshire, CH65 4FW

Dear Mr Evans

Bathampton footpath: Application for registration of a public right of way

A public footpath extending from the Kennet and Avon Canal towpath, Bathampton to Candy Bridge on Meadow Lane, has been used by the local community for many years but remains unregistered. Bathampton Parish Council is now applying for a Definitive Map Modification Order to register this path as a public right of way before the 2026 deadline. Under the Countryside and Wildlife Act 1981, applicants are required to notify landowners; please find attached official notification of this application.

If you have any questions relating to the matter, please contact myself or Councillor David Beard, whose email address is David.Beard@uwe.ac.uk.

Yours sincerely,

A solid black rectangular box used to redact the signature of Mrs. L. Daly.

Mrs. L. Daly
Clerk to Bathampton Parish Council

SUMMARY OF MODIFICATION ORDER APPLICATION

**Wildlife and Countryside Act 1981
The Definitive Map and Statement of Public Rights of Way
in Bath and North East Somerset**

Name and address of Applicant Mrs. L. Daly, Clerk to Bathampton Parish Council
67 69 Holcombe Close, Bathampton, Bath, BA2 6UP

Date of Application 21st February 2022

Description

*Please describe the route starting at one end and working through to the other end.
Describe any feature of note, roads, landmarks, buildings, hedges etc.
If the route has a name or nickname please give it here.*

This path runs from the north east side of Kennet and Avon Canal bridge number 185 (known as Candy Bridge) on Meadow Lane, taking an easterly direction through the wooded strip of land between the Network Rail boundary fence and the Kennet and Avon Canal boundary wall, and joining the Canal towpath to the east of Candy Bridge

.....

.....

.....

.....

.....

.....

.....

Length

*Please give the approximate length of the entire path in metres.
If you are claiming more than one path in the same application please give the length of each path separately.*

81 yards (approximately 74 metres)

Width

*Please give the full width of the path you are claiming.
Please also give the width of the claimed path as it is now*

Width claimed : 3-5 feet (variable)

Width now : 3-5 feet (variable)

Nature of surface

Please describe the surface of the path e.g. grass, made up track, ploughed, mud.

This path has a mud surface

Location of structures

Please give details and grid references for any gates, stiles, fences, bollards, barriers etc which are on the route now. Do not give details of fences if they run beside the route unless they are encroaching.

Structure	Grid Ref	Structure	Grid Ref	Structure	Grid Ref
The path crosses the Kennet & Avon Canal stone boundary wall, which forms a step down to the towpath	ST 76995 66216				
-----	-----	-----	-----	-----	-----
-----	-----	-----	-----	-----	-----
-----	-----	-----	-----	-----	-----

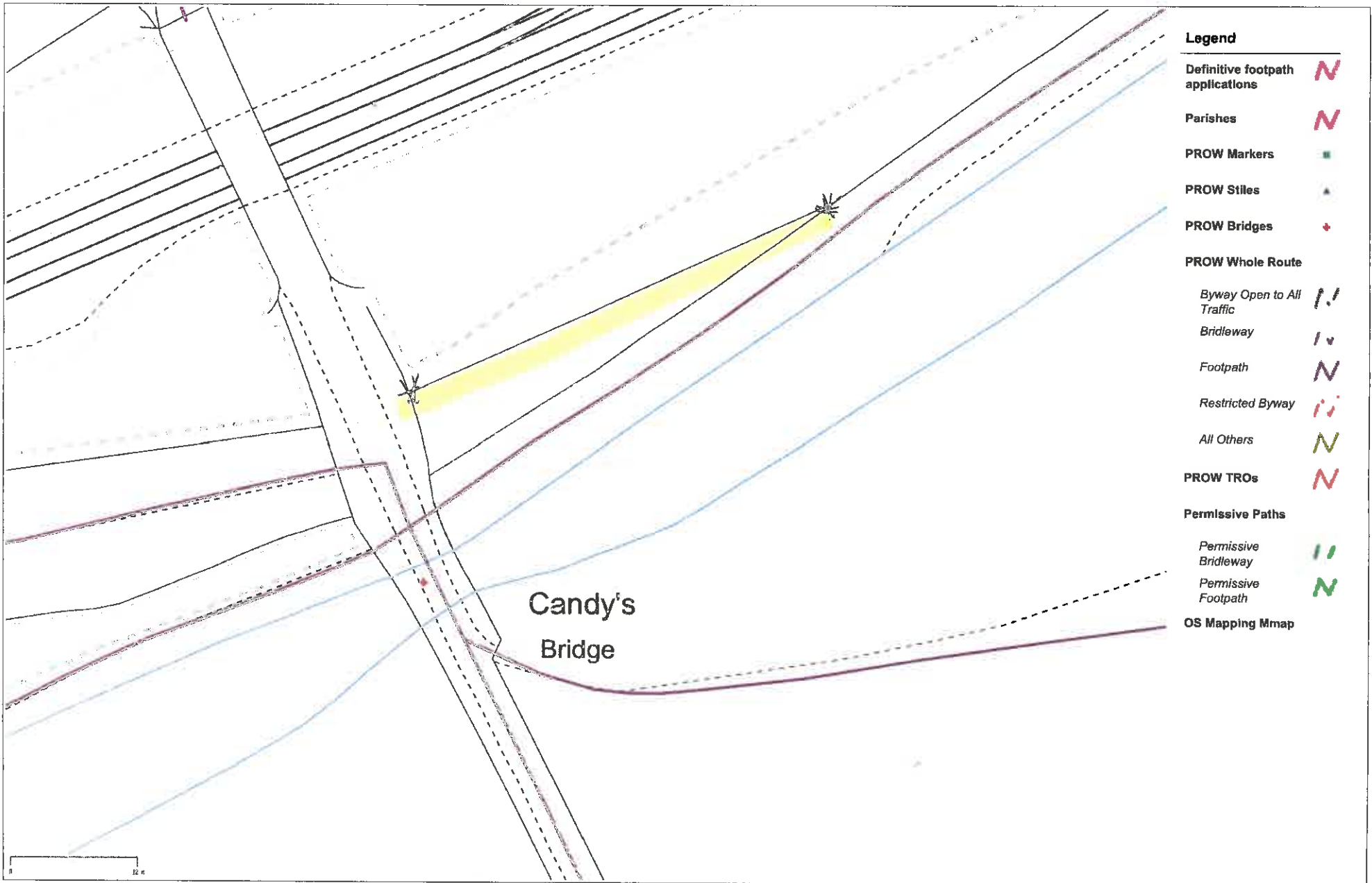

Legend	
Definitive footpath applications	
Parishes	
PROW Markers	
PROW Stiles	
PROW Bridges	
PROW Whole Route	
Byway Open to All Traffic	
Bridleway	
Footpath	
Restricted Byway	
All Others	
PROW TROs	
Permissive Paths	
Permissive Bridleway	
Permissive Footpath	
OS Mapping Mmap	