

WILDLIFE AND COUNTRYSIDE ACT 1981

Somerset County Council, Bathavon Rural District and Keynsham Urban District Definitive Map and Statement

Bath and North East Somerset Council (Public Footpath BA3/25, Meadow Park, Bathford) Definitive Map Modification Order 2022

This Order is made by Bath and North East Somerset Council under section 53(2)(b) of the Wildlife and Countryside Act 1981 ("the Act") because it appears to that authority that the Somerset County Council, Bathavon Rural District and Keynsham Urban District Definitive Map and Statement require modification in consequence of the occurrence of an event specified in section 53(3)(b) namely, the expiration, in relation to any way in the area to which the map relates, of any period such that the enjoyment by the public of the way during that period raises a presumption that the way has been dedicated as a public path or restricted byway.

The authority has consulted with every local authority whose area includes the land to which the Order relates. The Bath and North East Somerset Council hereby order that:

1. For the purposes of this Order the relevant date is 28nd July 2022.
2. The Somerset County Council, Bathavon Rural District and Keynsham Urban District Definitive Map and Statement shall be modified as described in Part I and Part II of the Schedule and shown on the map attached to the Order.
3. This Order shall take effect on the date it is confirmed and may be cited as the Bath and North East Somerset Council (Public Footpath BA3/25, Meadow Park, Bathford) Definitive Map Modification Order 2022.

Given under the Common Seal of the Bath and North East Somerset Council on the 28th day of July 2022.

The COMMON SEAL of the
BATH AND NORTH EAST SOMERSET
COUNCIL

was hereunto affixed
in the presence of:-



12920

Authorised signatory

In pursuance of its powers conferred by Schedule 15 of the Wildlife and Countryside Act 1981, the Council hereby confirms the above Order

The COMMON SEAL of the
BATH AND NORTH EAST SOMERSET
COUNCIL

was hereunto affixed
this day of 20
in the presence of:-

SCHEDULE

PART I

Modification of Definitive Map

Description of path or way to be added

A public footpath commencing from a junction with Meadow Park at grid reference ST 7869 6731 (point A on the Order Map) and proceeding in a generally easterly direction predominantly over a concrete path for 105 metres to a junction with public footpath BA3/24 at grid reference ST 7879 6731 (Point C on the Order Map).

PART II

Modification of Definitive Statement

Variation of particulars of path or way

A new statement for BA3/25 shall be recorded as follows:

Path Number: BA3/25

Status: Public footpath

Length: 105 metres

Parish: Bathford

Width: 1.3 metres between ST 7869 6731 and ST 7878 6731. Varying between 1.3 metres and 3 metres between ST 7878 6731 and ST 7879 6731 as shown shaded grey on the map forming part of the Bath and North East Somerset Council (Public Footpath BA3/25, Meadow Park, Bathford) Definitive Map Modification Order 2022

Limitations: The right of the landowner to erect and maintain a 1.8 metre wide gate at grid reference ST 7879 6731

Description of Route				
From		General Direction	To	
County Road or Right of Way	Grid Reference		County Road or Right of Way	Grid Reference
Meadow Park	ST 7869 6731	E	Public footpath BA3/24	ST 7879 6731

General Description:

A public footpath commencing from a junction with Meadow Park at grid reference ST 7869 6731 and proceeding in a generally easterly direction predominantly over a concrete path for 105 metres to a junction with public footpath BA3/24 at grid reference ST 7879 6731.

This map forms part of the Bath and North East Somerset Council (Public Footpath BA3/25, Meadow Park, Bathford) Definitive Map Modification Order 2022

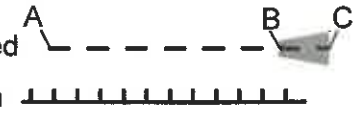
Public footpath to be added 
Unaffected public footpath

Scale 1:1250

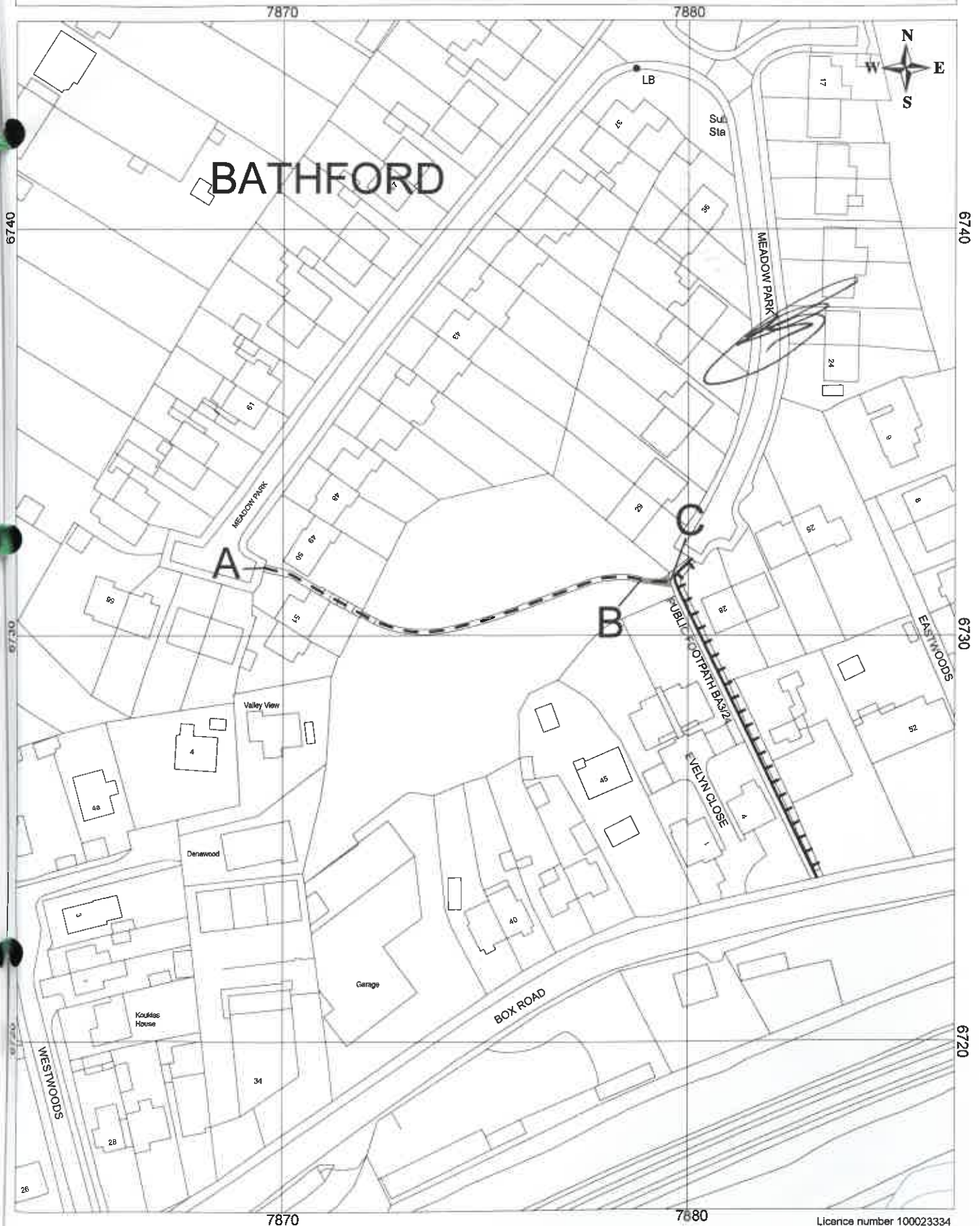

Licence number 100023334