

Proposed Modifications No. **M/C2/50**
Policy **NE.14 - Flooding (map 4 of 8)**
Recommendation Number **R10.22**
Extract From **Proposals Map Inset 31 (Bath City & Environs)
+ Map Inset 31A (Bath City)**

NOT TO SCALE

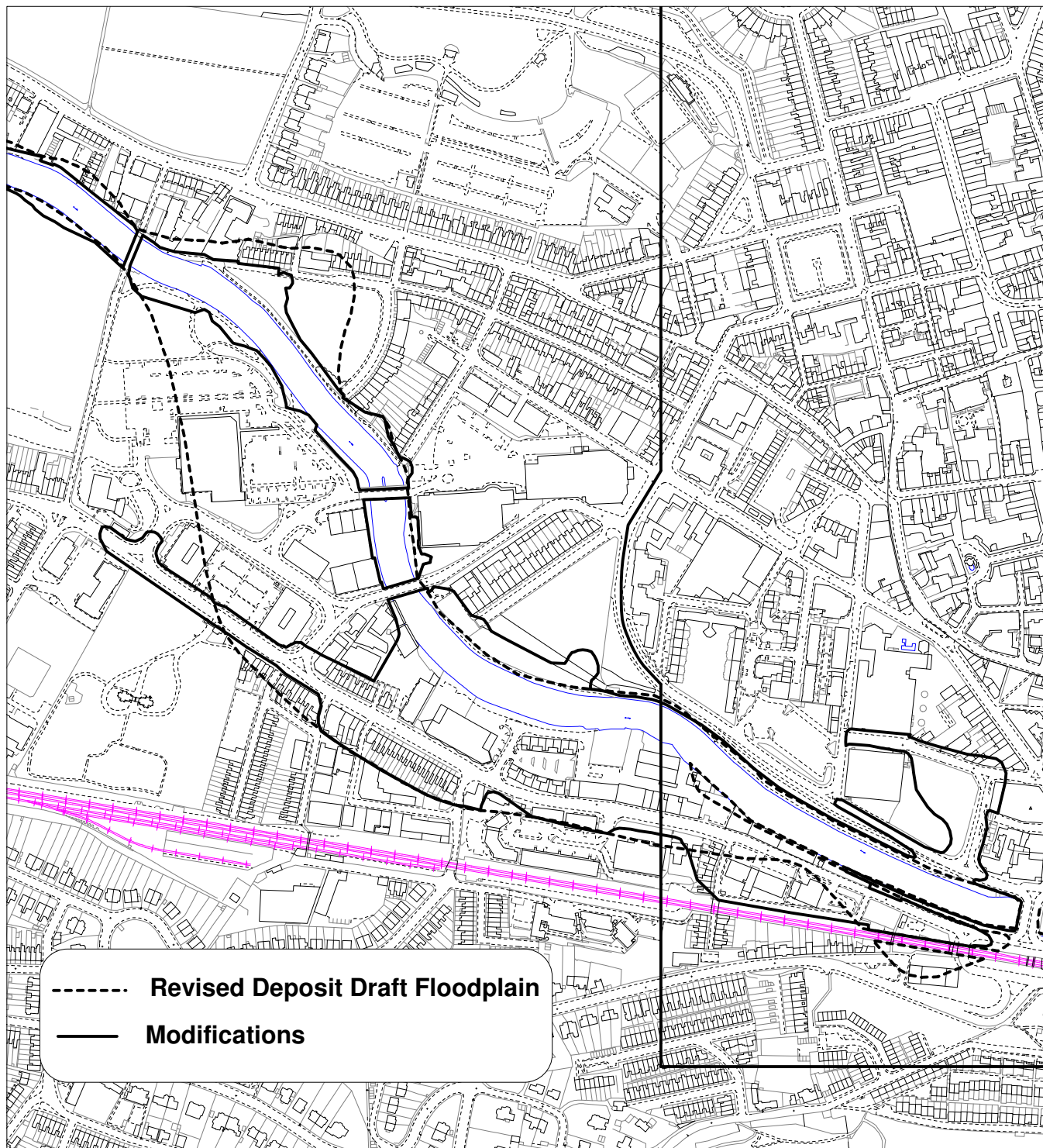

Reproduced from the Ordnance Survey mapping with the permission of the Controller of Her Majesty's Stationary Office
© Crown Copyright. Unauthorised reproduction infringes Crown copyright and may lead to prosecution or civil proceedings.



License number LA 06054L

PLEASE NOTE This proposed modification should be viewed with the Proposals Map Local Plan Deposit Draft
2002 + Revised Deposit Draft Changes to Proposals Map 2003