

New Planning Guidance

The Council has produced a user-friendly 'how to' guide to Sustainable Construction & Retrofitting. It includes:

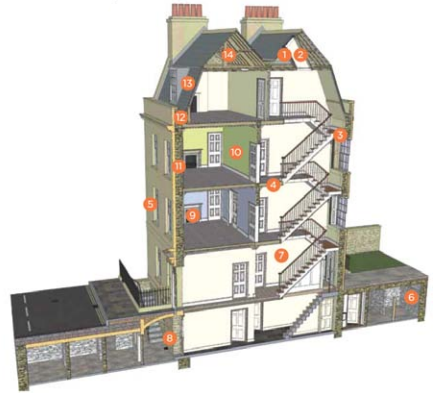

- 9 Sustainable construction principles to help you green any new build project
- Explanation of how the 5 main house types in the area are built
- Introduces 24 retrofit options from energy and water efficiency to heating and domestic renewable energy
- What planning, building control & listed building permissions you may need
- Local case studies and diagrams, photographs and sketches

If you are interested to find out what you can do without planning permission you can use our new Retrofitting Permitted Development Checklist.

More detailed guidance on energy efficiency and renewable energy for listed buildings is in development. For further information and to download your free copy of the documents visit our webpage:

www.bathnes.gov.uk/greenbuild

