

DO NOT SCALE

Millimetres

0 10 100

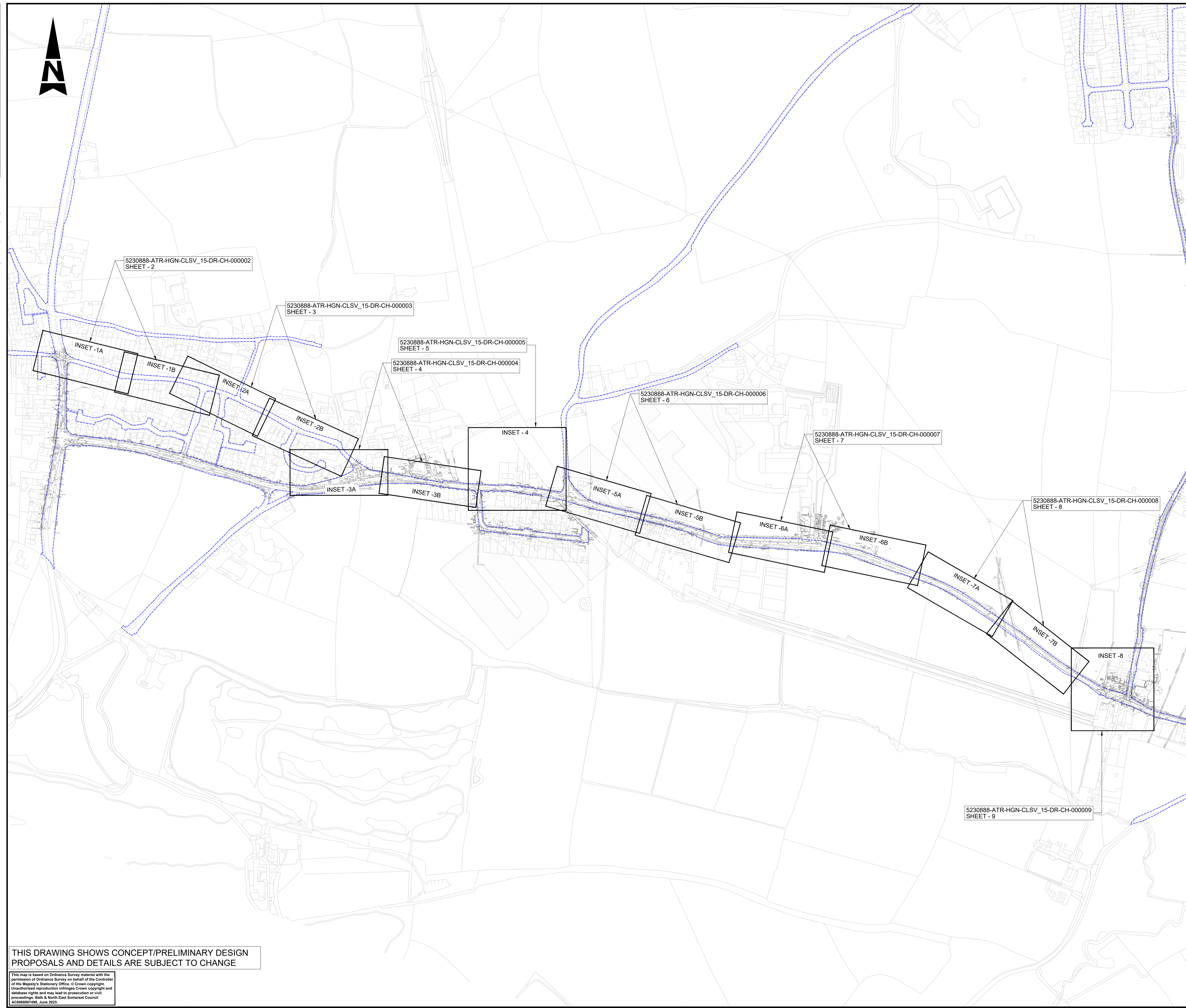
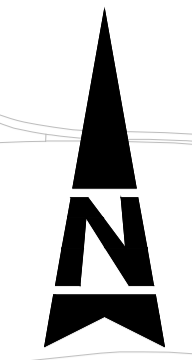

5230888-ATR-HGN-CLSV_15-DR-CH-000002
SHEET - 2

5230888-ATR-HGN-CLSV_15-DR-CH-000003
SHEET - 3

5230888-ATR-HGN-CLSV_15-DR-CH-000005
SHEET - 5

5230888-ATR-HGN-CLSV_15-DR-CH-000004
SHEET - 4

5230888-ATR-HGN-CLSV_15-DR-CH-000006
SHEET - 6

5230888-ATR-HGN-CLSV_15-DR-CH-000007
SHEET - 7

5230888-ATR-HGN-CLSV_15-DR-CH-000008
SHEET - 8

5230888-ATR-HGN-CLSV_15-DR-CH-000009
SHEET - 9

NOTES

- DO NOT SCALE FROM THIS DRAWING.
- ALL DIMENSIONS ARE IN METRES UNLESS OTHERWISE STATED.
- THIS DRAWING SHALL NOT BE USED FOR CONSTRUCTION PURPOSES.
- LIMITS OF WORK ARE APPROXIMATE AND ARE TO BE AGREED ON SITE WITH THE OVERSEEING ORGANISATION.
- HEALTH AND SAFETY:
IT IS THE CONTRACTOR'S RESPONSIBILITY TO BE AWARE OF ALL STATUTORY UNDERTAKERS' PLANT THAT MAY BE LOCATED WITHIN THE SITE.
- PROPOSED TRAFFIC SIGNS AND ROAD MARKINGS TYPE/COLOURS AND DIMENSIONS SHALL BE IN ACCORDANCE WITH TSRGD 2016 AND SUBSEQUENT AMENDMENTS.
- LIGHTING AND TRAFFIC SIGNAL (IF ANY) PROPOSAL TO BE FINALISED AT DETAILED DESIGN STAGE.

KEY
— EXISTING HIGHWAY BOUNDARY

SAFETY, HEALTH AND ENVIRONMENTAL INFORMATION

In addition to the hazards/risks normally associated with the types of work detailed on this drawing, note the following significant residual risks (Reference shall also be made to the design hazard log).

Construction
Presence of 11KV electric overhead line
Maintenance / Cleaning
None
Use
None
Decommissioning / Demolition
None

Description	Status	Revision	Drawn	Checked	Reviewed	Authorised	Issue Date
Description	Status	Revision	Drawn	Checked	Reviewed	Authorised	Issue Date
Description	Status	Revision	Drawn	Checked	Reviewed	Authorised	Issue Date
Description	Status	Revision	Drawn	Checked	Reviewed	Authorised	Issue Date

For Public Consultation							Status
S2	P01	---	---	---	---	---	30/01/25
Drawing Suitability							Status
FOR INFORMATION							S2

AtkinsRéalis Aztec West
500 Park Avenue
Almondsbury
Bristol
BS32 4RZ
Tel: +44 (0)1454 662000
+44 (0)1454 663333
www.atkinsrealis.com

Copyright © AtkinsRéalis (2025)

Bath & North East Somerset Council
Improving People's Lives

Project Title
Somer Valley Links FBC

Drawing Title
**GENERAL ARRANGEMENT
A362 CYCLING ROUTE
(SHEET 1 OF 9)**

Project	Originator	Volume		
5230888	- ATR	- HGN -		
CLSV_15	- DR - CH - 000001			
Location	Type	Role	Number	
Original Size: A1	Scale: NTS	Project Ref. No: 5230888	Sheet: 1 of 1	Rev: P01

THIS DRAWING SHOWS CONCEPT/PRELIMINARY DESIGN PROPOSALS AND DETAILS ARE SUBJECT TO CHANGE

This map is based on Ordnance Survey material with the permission of Ordnance Survey on behalf of the Controller of the Major's Stationery Office. © Crown copyright. Unauthorised reproduction infringes Crown copyright and database rights and may lead to prosecution or civil proceedings. Bath & North East Somerset Council AC200807488, June 2023

100
Millimetres
0 10
DO NOT SCALE

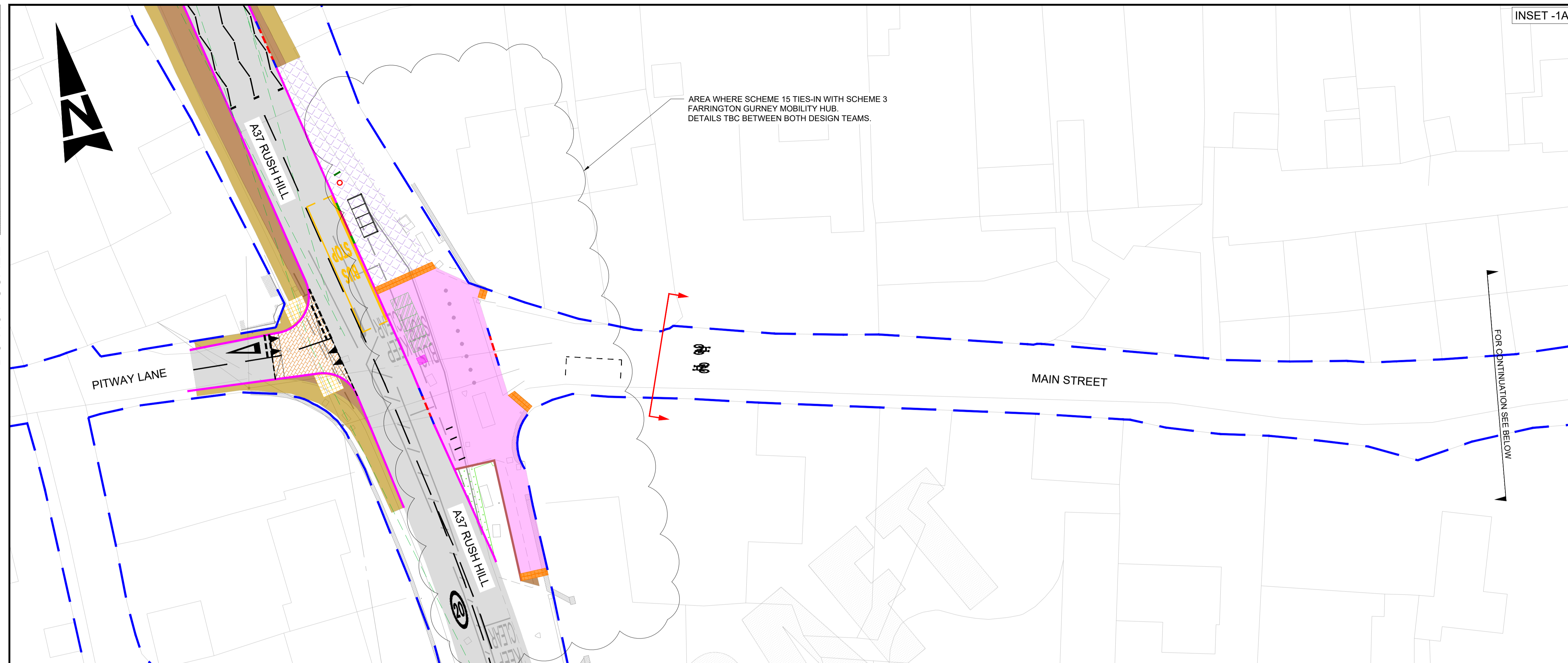

INSET -1A

- NOTES**
- DO NOT SCALE FROM THIS DRAWING.
 - ALL DIMENSIONS ARE IN METRES UNLESS OTHERWISE STATED.
 - THIS DRAWING SHALL NOT BE USED FOR CONSTRUCTION PURPOSES.
 - LIMITS OF WORK ARE APPROXIMATE AND ARE TO BE AGREED ON SITE WITH THE OVERSEEING ORGANISATION.
 - HEALTH AND SAFETY:
IT IS THE CONTRACTOR'S RESPONSIBILITY TO BE AWARE OF ALL STATUTORY UNDERTAKERS' PLANT THAT MAY BE LOCATED WITHIN THE SITE.
 - PROPOSED TRAFFIC SIGNS AND ROAD MARKINGS TYPE/COLOURS AND DIMENSIONS SHALL BE IN ACCORDANCE WITH TSRGD 2016 AND SUBSEQUENT AMENDMENTS.
 - LIGHTING AND TRAFFIC SIGNAL (IF ANY) PROPOSAL TO BE FINALISED AT DETAILED DESIGN STAGE.

- KEY**
- EXISTING HIGHWAY BOUNDARY
 - PROPOSED COLOURED SURFACING
 - SITE EXTENTS

SAFETY, HEALTH AND ENVIRONMENTAL INFORMATION

In addition to the hazards/risks normally associated with the types of work detailed on this drawing, note the following significant residual risks (Reference shall also be made to the design hazard log).

Construction	Presence of 11KV electric overhead line
Maintenance / Cleaning	None
Use	None

Decommissioning / Demolition	None
------------------------------	------

Description	Status	Revision	Drawn	Checked	Reviewed	Authorised	Issue Date
Description							
Description							
Description							
Description							

Description							For Public Consultation
Status	Revision	Drawn	Checked	Reviewed	Authorised	Issue Date	
S2	P01	---	---	---	---	30/01/25	
Drawing Suitability							Status
FOR INFORMATION							S2

AtkinsRéalis
 Aztec West
 500 Park Avenue
 Almondsbury
 Bristol
 BS32 4RZ
 Tel: +44 (0)1454 662000
 +44 (0)1454 663333
 www.atkinsrealis.com

Copyright © AtkinsRéalis (2025)

Bath & North Somerset Council
 Improving People's Lives

Client
 Somer Valley Links FBC

Drawing Title
 GENERAL ARRANGEMENT
 A362 CYCLING ROUTE
 (SHEET 2 OF 9)

Project	Originator	Volume		
5230888	- ATR - HGN -			
CLSV_15	- DR - CH - 000002			
Location	Type	Role	Number	
Original Size: A1	Scale: 1:250	Project Ref. No: 5230888	Sheet: 2 of 9	Rev: P01



INSET -1B

THIS DRAWING SHOWS CONCEPT/PRELIMINARY DESIGN PROPOSALS AND DETAILS ARE SUBJECT TO CHANGE

This map is based on Ordnance Survey material with the permission of Ordnance Survey on behalf of the Controller of the Majesty's Stationary Office. © Crown copyright. Unauthorised reproduction infringes Crown copyright and database rights and may lead to prosecution or civil proceedings. Bath & North East Somerset Council. AC200807488, June 2023.

DO NOT SCALE

Millimetres

0 10 100

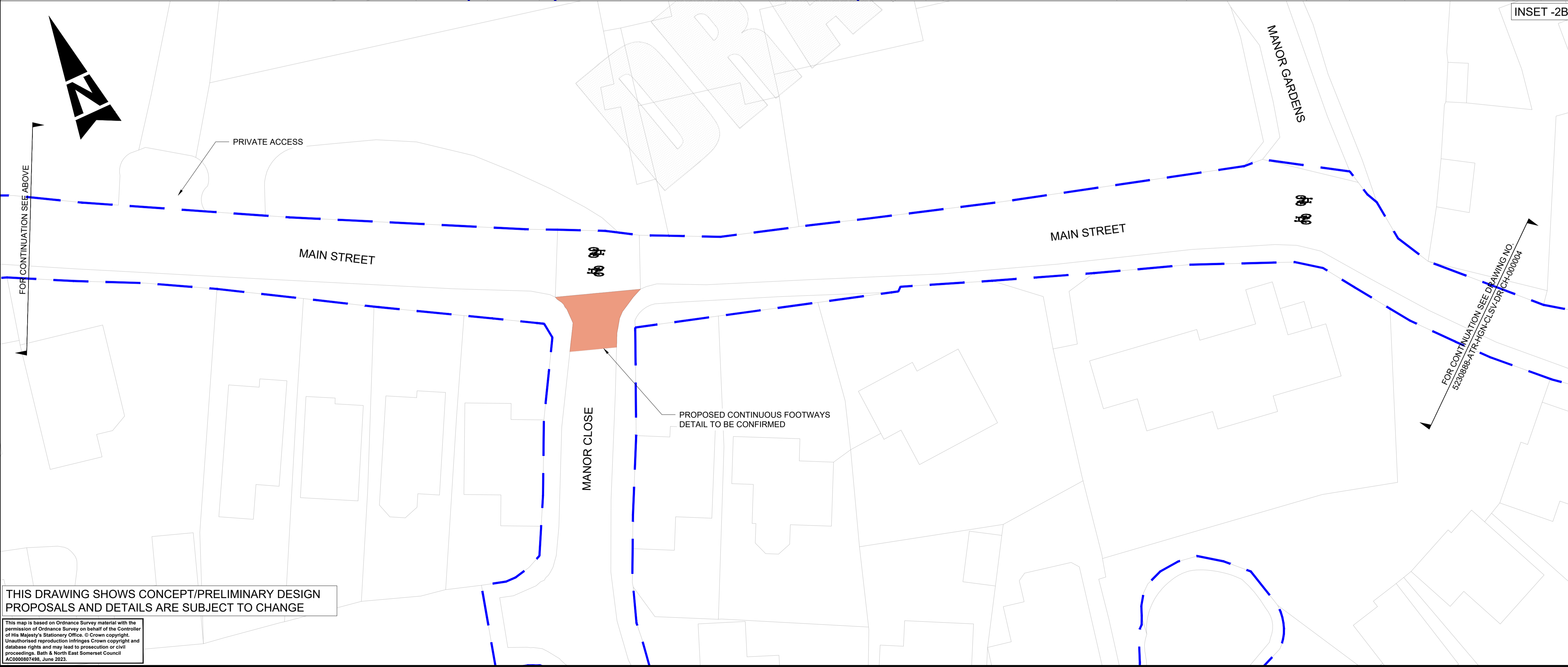
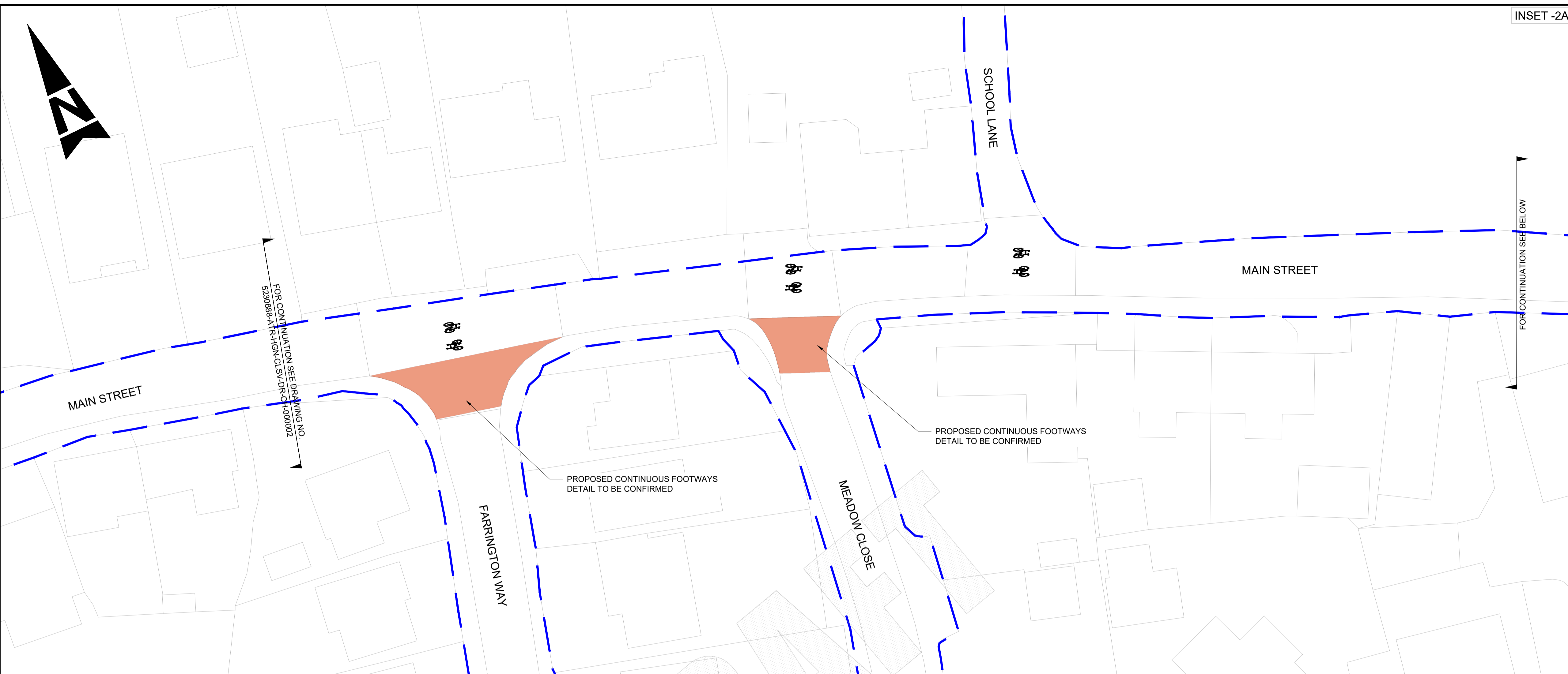

INSET -2A

INSET -2B

- NOTES**
- DO NOT SCALE FROM THIS DRAWING.
 - ALL DIMENSIONS ARE IN METRES UNLESS OTHERWISE STATED.
 - THIS DRAWING SHALL NOT BE USED FOR CONSTRUCTION PURPOSES.
 - LIMITS OF WORK ARE APPROXIMATE AND ARE TO BE AGREED ON SITE WITH THE OVERSEEING ORGANISATION.
 - HEALTH AND SAFETY:
IT IS THE CONTRACTOR'S RESPONSIBILITY TO BE AWARE OF ALL STATUTORY UNDERTAKERS' PLANT THAT MAY BE LOCATED WITHIN THE SITE.
 - PROPOSED TRAFFIC SIGNS AND ROAD MARKINGS TYPE/COLOURS AND DIMENSIONS SHALL BE IN ACCORDANCE WITH TSRGD 2016 AND SUBSEQUENT AMENDMENTS.
 - LIGHTING AND TRAFFIC SIGNAL (IF ANY) PROPOSAL TO BE FINALISED AT DETAILED DESIGN STAGE.

- KEY**
- EXISTING HIGHWAY BOUNDARY
 - PROPOSED COLOURED SURFACING
 - SITE EXTENTS

SAFETY, HEALTH AND ENVIRONMENTAL INFORMATION

In addition to the hazards/risks normally associated with the types of work detailed on this drawing, note the following significant residual risks (Reference shall also be made to the design hazard log).

Construction	Presence of 11KV electric overhead line
Maintenance / Cleaning	None
Use	None
Decommissioning / Demolition	None

Description	Status	Revision	Drawn	Checked	Reviewed	Authorised	Issue Date
Description	Status	Revision	Drawn	Checked	Reviewed	Authorised	Issue Date
Description	Status	Revision	Drawn	Checked	Reviewed	Authorised	Issue Date
Description	Status	Revision	Drawn	Checked	Reviewed	Authorised	Issue Date

For Public Consultation

Status	Revision	Drawn	Checked	Reviewed	Authorised	Issue Date
S2	P01	---	---	---	---	30/01/25

Drawing Suitability: **FOR INFORMATION** Status: **S2**

AtkinsRéalis Aztec West
500 Park Avenue
Almondsbury
Bristol
BS32 4RZ
Tel: +44 (0)1454 662000
+44 (0)1454 663333
www.atkinsrealis.com

Copyright © AtkinsRéalis (2025)

Client
Bath & North East Somerset Council
Improving People's Lives

Project Title
Somer Valley Links FBC

Drawing Title
**GENERAL ARRANGEMENT
A362 CYCLING ROUTE
(SHEET 3 OF 9)**

Project	Originator	Volume	
5230888	- ATR	- HGN -	
CLSV_15	- DR	- CH - 000003	
Location	Type	Role	Number
A1	1:250	Project Ref. No.	5230888
Original Size:	Scale:	Project Ref. No.:	5230888
		Sheet:	3 of 9
		Rev.:	P01

THIS DRAWING SHOWS CONCEPT/PRELIMINARY DESIGN PROPOSALS AND DETAILS ARE SUBJECT TO CHANGE

This map is based on Ordnance Survey material with the permission of Ordnance Survey on behalf of the Controller of Her Majesty's Stationary Office. © Crown copyright. Unauthorised reproduction infringes Crown copyright and database rights and may lead to prosecution or civil proceedings. Bath & North East Somerset Council AC2000807488, June 2023

DO NOT SCALE

Millimetres

0 10

100

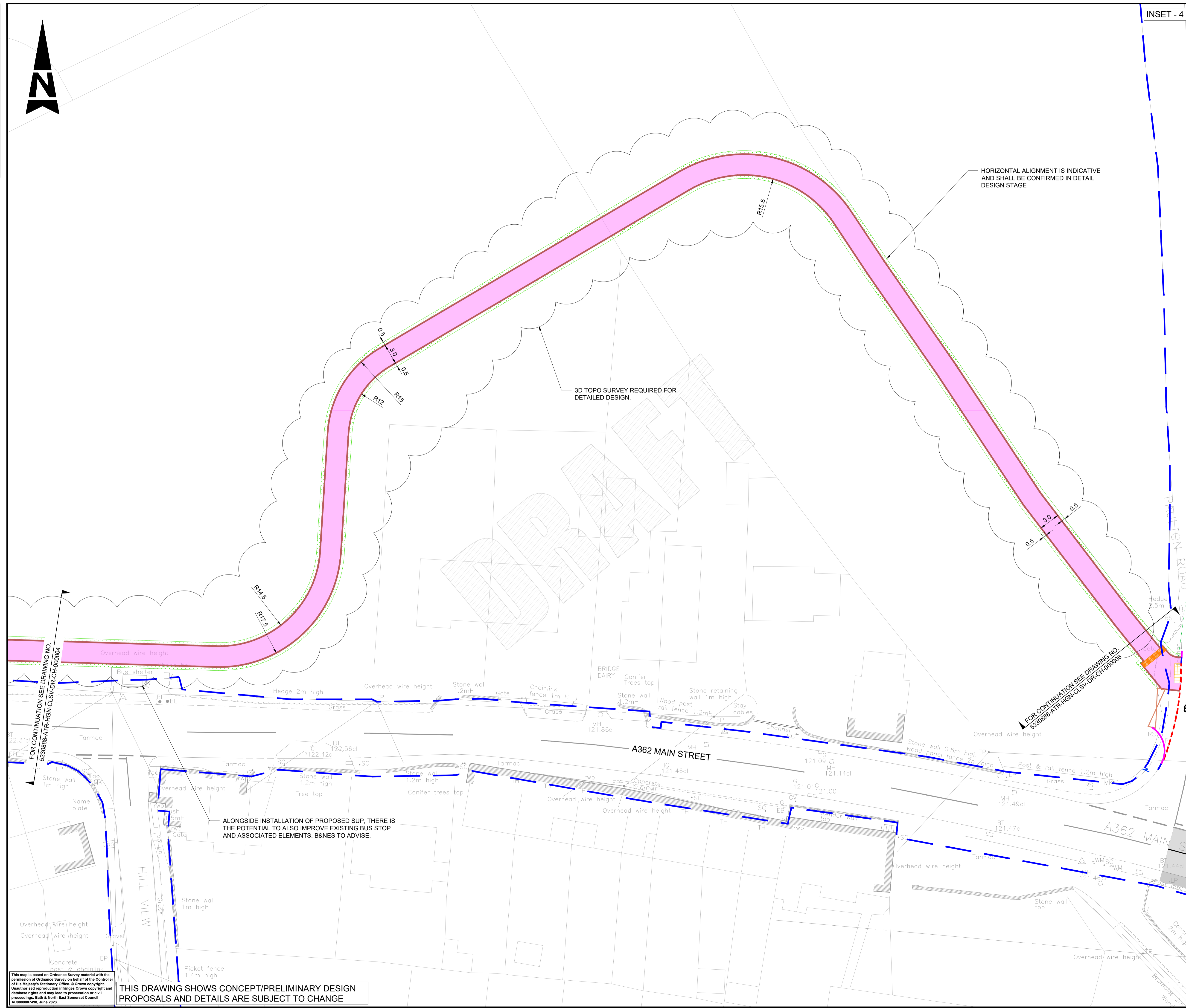
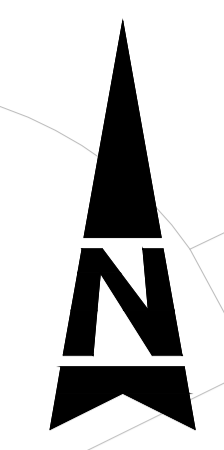

INSET - 4

- NOTES**
- DO NOT SCALE FROM THIS DRAWING.
 - ALL DIMENSIONS ARE IN METRES UNLESS OTHERWISE STATED.
 - THIS DRAWING SHALL NOT BE USED FOR CONSTRUCTION PURPOSES.
 - LIMITS OF WORK ARE APPROXIMATE AND ARE TO BE AGREED ON SITE WITH THE OVERSEEING ORGANISATION.
 - HEALTH AND SAFETY:
IT IS THE CONTRACTOR'S RESPONSIBILITY TO BE AWARE OF ALL STATUTORY UNDERTAKERS' PLANT THAT MAY BE LOCATED WITHIN THE SITE.
 - PROPOSED TRAFFIC SIGNS AND ROAD MARKINGS TYPE/COLOURS AND DIMENSIONS SHALL BE IN ACCORDANCE WITH TSRGD 2016 AND SUBSEQUENT AMENDMENTS.
 - LIGHTING AND TRAFFIC SIGNAL (IF ANY) PROPOSAL TO BE FINALISED AT DETAILED DESIGN STAGE.

- KEY**
- EXISTING HIGHWAY BOUNDARY
 - PROPOSED HALF BATTERED KERB (HB2) (UPSTAND TO MATCH WITH THE EXISTING)
 - PROPOSED TRANSITION KERB BETWEEN HB2 & BN
 - PROPOSED BULLNOSE KERB (BN) (UPSTAND 0-6mm)
 - PROPOSED FLAT TOPPED EDGING (EF)
 - PROPOSED ROAD MARKINGS
 - PROPOSED SHARED USE PATH
 - PROPOSED VERGE
 - PROPOSED BLISTER TACTILE PAVING (BUFF COLOUR)
 - PROPOSED CORDUROY HAZARD PAVING
 - SITE EXTENTS

SAFETY, HEALTH AND ENVIRONMENTAL INFORMATION

In addition to the hazards/risks normally associated with the types of work detailed on this drawing, note the following significant residual risks (Reference shall also be made to the design hazard log).

Construction	Presence of 11kV electric overhead line
Maintenance / Cleaning	None
Use	None
Decommissioning / Demolition	None

Description	Status	Revision	Drawn	Checked	Reviewed	Authorised	Issue Date

For Public Consultation							Status
Status	Revision	Drawn	Checked	Reviewed	Authorised	Issue Date	
S2	P01	---	---	---	---	30/01/25	S2

FOR INFORMATION

AtkinsRéalis Aztec West
500 Park Avenue
Almondsbury
Bristol
BS32 4RZ
Tel: +44 (0)1454 662000
+44 (0)1454 663333
www.atkinsrealis.com

Copyright © AtkinsRéalis (2025)

Bath & North Somerset Council

Improving People's Lives

Project Title: Somer Valley Links FBC

Drawing Title: GENERAL ARRANGEMENT A362 CYCLING ROUTE (SHEET 5 OF 9)

Drawing Number: 5230888 - ATR - HGN - CLSV_15 - DR - CH - 000005

Project: 5230888 | Originator: ATR | Volume: HGN - CLSV_15 - DR - CH - 000005

Original Size: A1 | Scale: 1:250 | Project Ref. No: 5230888 | Sheet: 5 of 9 | Rev: P01

This map is based on Ordnance Survey material with the permission of Ordnance Survey on behalf of the Controller of the Majesty's Stationary Office. © Crown copyright. Unauthorised reproduction infringes Crown copyright and database rights and may lead to prosecution or civil proceedings. Bath & North East Somerset Council AC200807486, June 2023.

THIS DRAWING SHOWS CONCEPT/PRELIMINARY DESIGN PROPOSALS AND DETAILS ARE SUBJECT TO CHANGE

DO NOT SCALE

Millimetres

0 10

100

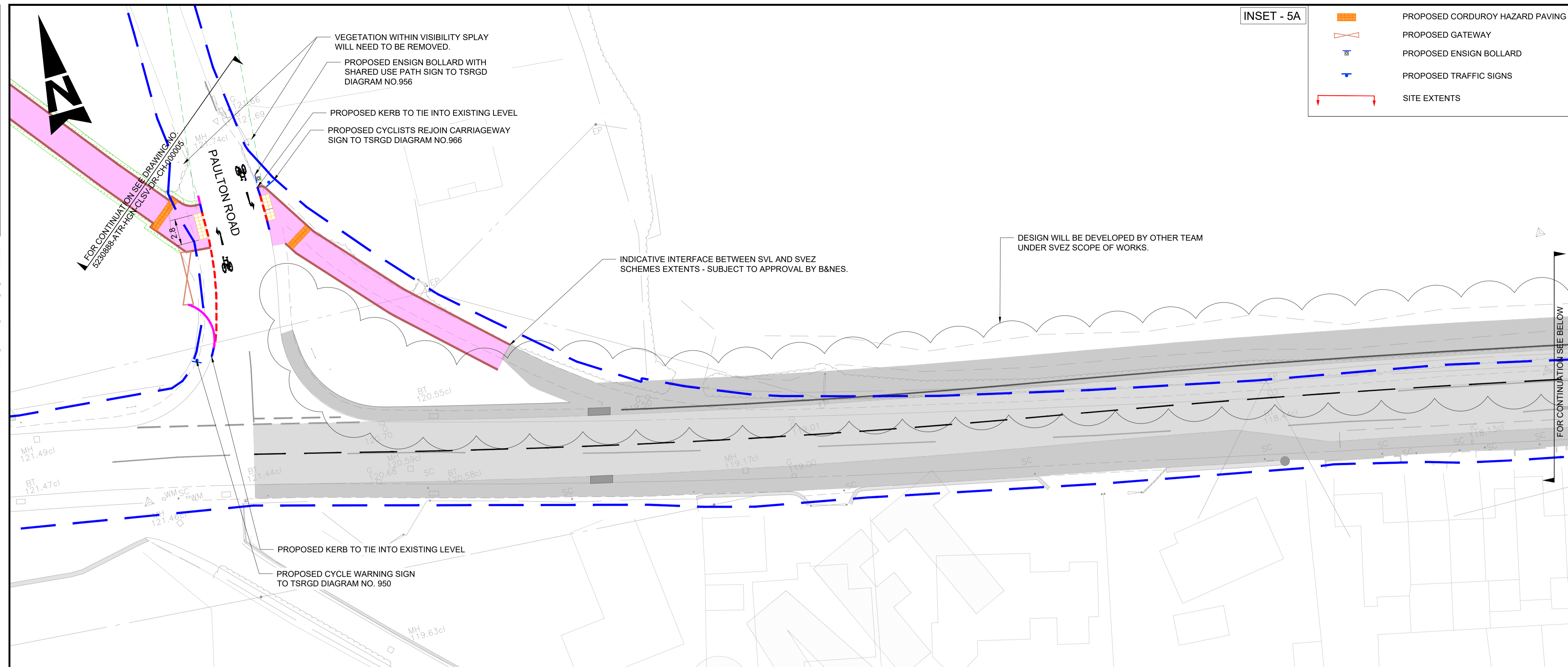

INSET - 5A

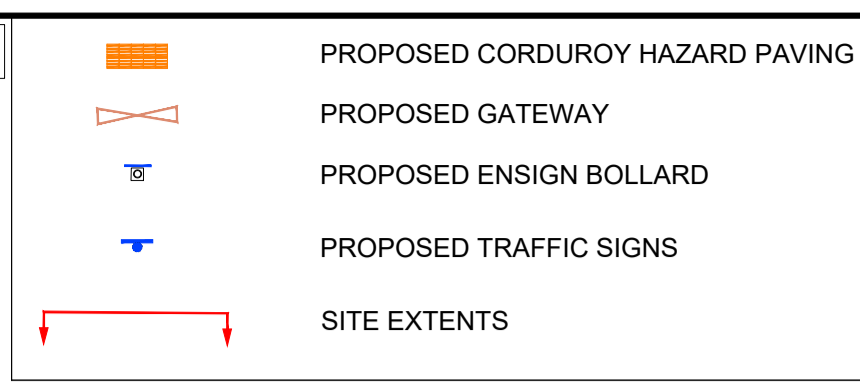

- NOTES**
- DO NOT SCALE FROM THIS DRAWING.
 - ALL DIMENSIONS ARE IN METRES UNLESS OTHERWISE STATED.
 - THIS DRAWING SHALL NOT BE USED FOR CONSTRUCTION PURPOSES.
 - LIMITS OF WORK ARE APPROXIMATE AND ARE TO BE AGREED ON SITE WITH THE OVERSEEING ORGANISATION.
 - HEALTH AND SAFETY: IT IS THE CONTRACTOR'S RESPONSIBILITY TO BE AWARE OF ALL STATUTORY UNDERTAKERS' PLANT THAT MAY BE LOCATED WITHIN THE SITE.
 - PROPOSED TRAFFIC SIGNS AND ROAD MARKINGS TYPE/COLOURS AND DIMENSIONS SHALL BE IN ACCORDANCE WITH TSRGD 2016 AND SUBSEQUENT AMENDMENTS.
 - LIGHTING AND TRAFFIC SIGNAL (IF ANY) PROPOSAL TO BE FINALISED AT DETAILED DESIGN STAGE.
 - ALL STREET LIGHTING COLUMNS AND TELEGRAPH POLES WITHIN THE EXTENTS OF THE PROPOSED SUP WILL NEED TO BE RELOCATED. STREET LIGHTING PROVISION TO BE CONFIRMED AT DETAILED DESIGN STAGE.
 - POTENTIAL FOR SUP TO BE SEPARATED FROM PRIVATE LAND BY FENCING. TBC AT DETAILED DESIGN STAGE.

- KEY**
- EXISTING HIGHWAY BOUNDARY
 - PROPOSED HALF BATTERED KERB (HB2) (UPSTAND TO MATCH WITH THE EXISTING)
 - PROPOSED TRANSITION KERB BETWEEN HB2 & BN
 - PROPOSED BULLNOSE KERB (BN) (UPSTAND 0-6mm)
 - PROPOSED FLAT TOPPED EDGING (EF)
 - PROPOSED ROAD MARKINGS
 - PROPOSED SHARED USE PATH
 - PROPOSED VERGE
 - PROPOSED BLISTER TACTILE PAVING (BUFF COLOUR)

SAFETY, HEALTH AND ENVIRONMENTAL INFORMATION

In addition to the hazards/risks normally associated with the types of work detailed on this drawing, note the following significant residual risks (Reference shall also be made to the design hazard log).

Construction
Presence of 11kV electric overhead line

Maintenance / Cleaning
None

Use
None

Decommissioning / Demolition
None

Description	Status	Revision	Drawn	Checked	Reviewed	Authorised	Issue Date

For Public Consultation							
Status	Revision	Drawn	Checked	Reviewed	Authorised	Issue Date	Status
S2	P01	---	---	---	---	30/01/25	S2

FOR INFORMATION

AtkinsRéalis Aztec West
500 Park Avenue
Almondsbury
Bristol
BS32 4RZ
Tel: +44 (0)1454 662000
+44 (0)1454 663333
www.atkinsrealis.com

Copyright © AtkinsRéalis (2025)

Bath & North Somerset Council
Improving People's Lives

Project Title
Somerset Valley Links FBC

Drawing Title
GENERAL ARRANGEMENT
A362 CYCLING ROUTE
(SHEET 6 OF 9)

Drawing Number Project 5230888	Originator - ATR	Volume - HGN
CLSV_15 - DR - CH - 000006		
Location	Type	Role
Original Size: A1	Scale: 1:250	Project Ref. No: 5230888
Sheet: 6 of 9	Rev: P01	

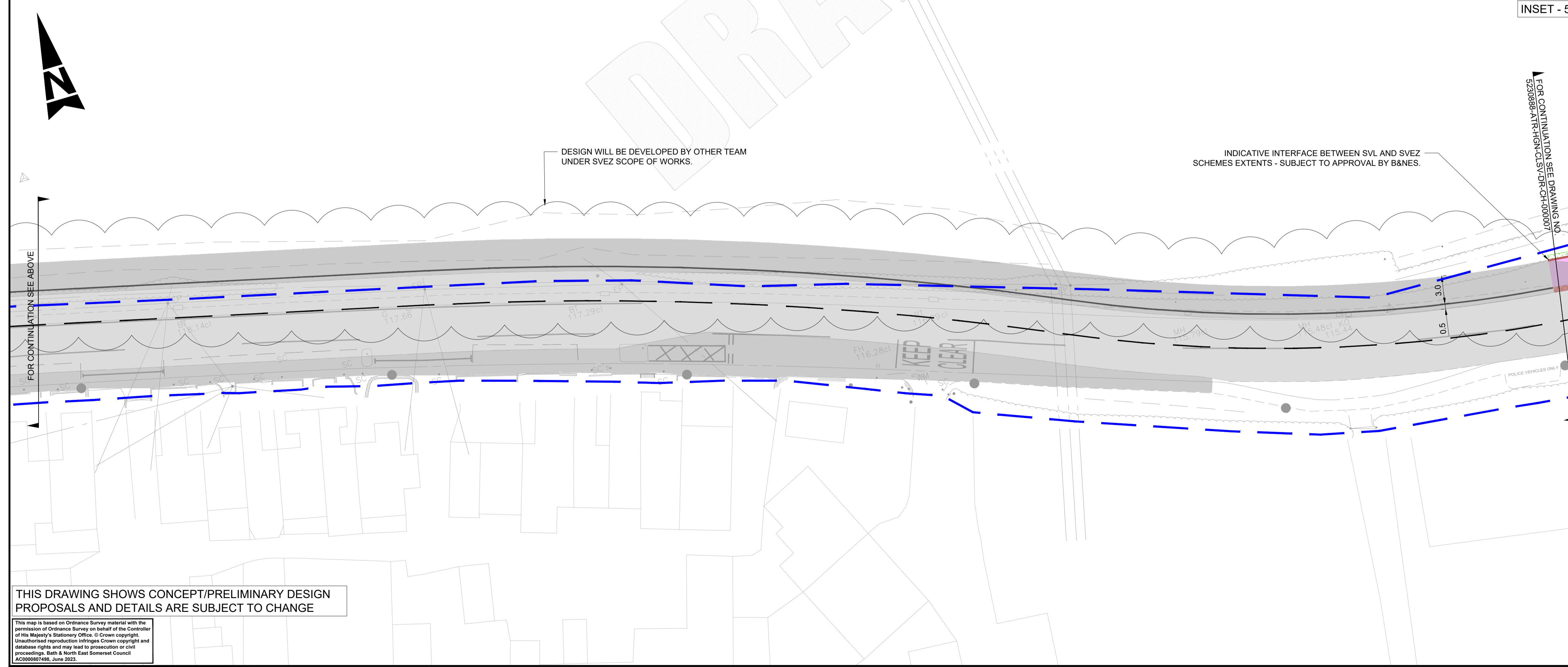

INSET - 5B

FOR CONTINUATION SEE DRAWING NO. 5230888-ATR-HGN-CLSV-DR-CH-000007

THIS DRAWING SHOWS CONCEPT/PRELIMINARY DESIGN PROPOSALS AND DETAILS ARE SUBJECT TO CHANGE

This map is based on Ordnance Survey material with the permission of Ordnance Survey on behalf of the Controller of the Major's Stationery Office. © Crown copyright. Unauthorised reproduction infringes Crown copyright and database rights and may lead to prosecution or civil proceedings. Bath & North East Somerset Council AC200007486, June 2023

DO NOT SCALE

Millimetres

0 10

100

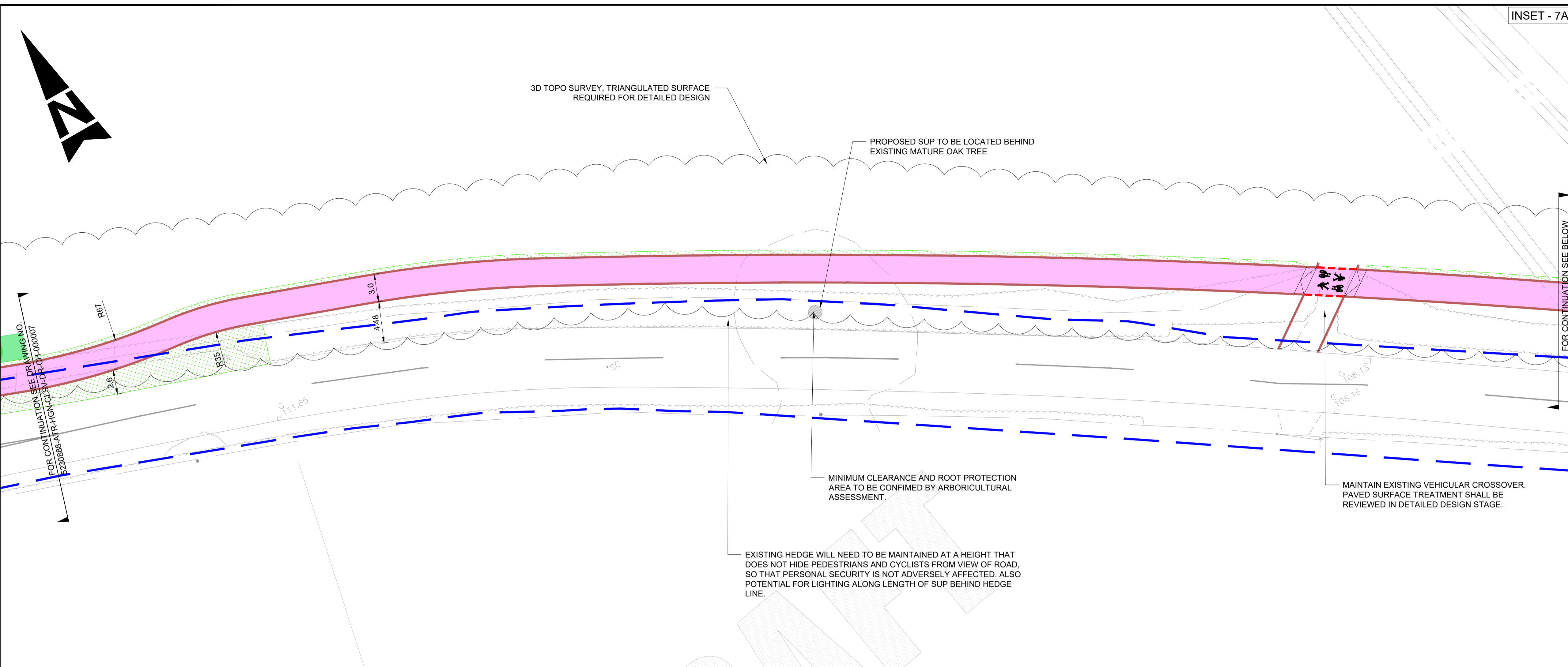

INSET - 7A

- NOTES**
- DO NOT SCALE FROM THIS DRAWING.
 - ALL DIMENSIONS ARE IN METRES UNLESS OTHERWISE STATED.
 - THIS DRAWING SHALL NOT BE USED FOR CONSTRUCTION PURPOSES.
 - LIMITS OF WORK ARE APPROXIMATE AND ARE TO BE AGREED ON SITE WITH THE OVERSEEING ORGANISATION.
 - HEALTH AND SAFETY: IT IS THE CONTRACTOR'S RESPONSIBILITY TO BE AWARE OF ALL STATUTORY UNDERTAKERS' PLANT THAT MAY BE LOCATED WITHIN THE SITE.
 - PROPOSED TRAFFIC SIGNS AND ROAD MARKINGS TYPE/COLOURS AND DIMENSIONS SHALL BE IN ACCORDANCE WITH TSRGD 2016 AND SUBSEQUENT AMENDMENTS.
 - LIGHTING AND TRAFFIC SIGNAL (IF ANY) PROPOSAL TO BE FINALISED AT DETAILED DESIGN STAGE.
 - ALL STREET LIGHTING COLUMNS AND TELEGRAPH POLES WITHIN THE EXTENTS OF THE PROPOSED SUP WILL NEED TO BE RELOCATED. STREET LIGHTING PROVISION TO BE CONFIRMED AT DETAILED DESIGN STAGE.
 - POTENTIAL FOR SUP TO BE SEPARATED FROM PRIVATE LAND BY FENCING. TBC AT DETAILED DESIGN STAGE.

- KEY**
- EXISTING HIGHWAY BOUNDARY
 - PROPOSED FLAT TOPPED EDGING (EF)
 - PROPOSED ROAD MARKINGS
 - PROPOSED SHARED USE PATH
 - PROPOSED SEPARATOR
 - PROPOSED VERGE
 - PROPOSED RAMP
 - PROPOSED LANDSCAPING/ HEDGE
 - SITE EXTENTS

SAFETY, HEALTH AND ENVIRONMENTAL INFORMATION

In addition to the hazards/risks normally associated with the types of work detailed on this drawing, note the following significant residual risks (Reference shall also be made to the design hazard log).

Construction	Presence of 11KV electric overhead line
Maintenance / Cleaning	None
Use	None
Decommissioning / Demolition	None

Description	Status	Revision	Drawn	Checked	Reviewed	Authorised	Issue Date

Description							Issue Date
For Public Consultation							30/01/25
Status	Revision	Drawn	Checked	Reviewed	Authorised	Issue Date	
S2	P01	---	---	---	---	---	
Drawing Suitability							Status
FOR INFORMATION							S2

AtkinsRéalis
 Aztec West
 500 Park Avenue
 Almondsbury
 Bristol
 BS32 4RZ
 Tel: +44 (0)1454 662000
 +44 (0)1454 663333
 www.atkinsrealis.com

Bath & North East Somerset Council
 Improving People's Lives

Project Title
Somer Valley Links FBC

Drawing Title
**GENERAL ARRANGEMENT
 A362 CYCLING ROUTE
 (SHEET 8 OF 9)**

Drawing Number	Project	Originator	Volume
5230888	-	ATR	- HGN -
Location		Type	Role
CLS_V_15		-	DR - CH - 000008
Original Size	Scale	Project Ref. No.	Sheet
A1		5230888	8 of 9
			Rev. P01

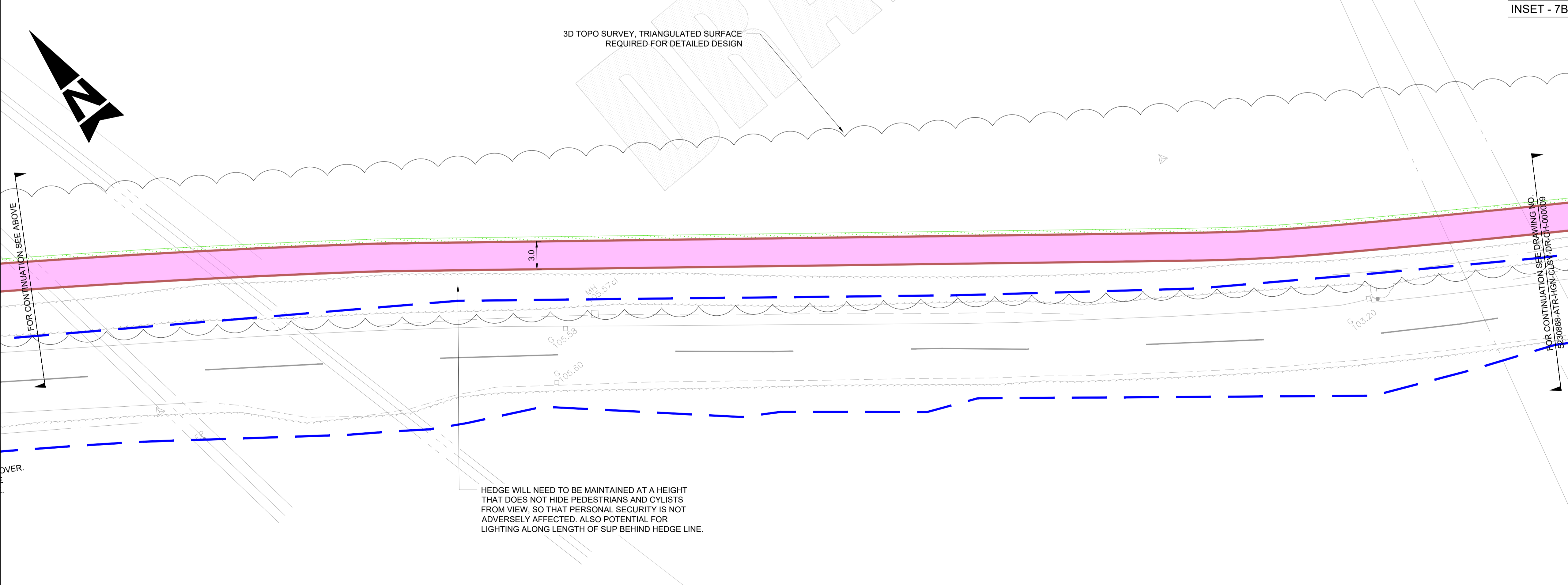

INSET - 7B

THIS DRAWING SHOWS CONCEPT/PRELIMINARY DESIGN PROPOSALS AND DETAILS ARE SUBJECT TO CHANGE

This map is based on Ordnance Survey material with the permission of Ordnance Survey on behalf of the Controller of the Major's Stationery Office. © Crown copyright. Unauthorised reproduction infringes Crown copyright and database rights and may lead to prosecution or civil proceedings. Bath & North East Somerset Council AC200807488, June 2023

DO NOT SCALE

Millimetres

0 10



HEDGE WILL NEED TO BE MAINTAINED AT A HEIGHT THAT DOES NOT HIDE PEDESTRIANS AND CYCLISTS FROM VIEW, SO THAT PERSONAL SECURITY IS NOT ADVERSELY AFFECTED. ALSO POTENTIAL FOR LIGHTING ALONG LENGTH OF SUP BEHIND HEDGE LINE.

3D TOPO SURVEY, TRIANGULATED SURFACE REQUIRED FOR DETAILED DESIGN

ALIGNMENT OF PROPOSED SUP AT THIS PINCH POINT HAS BEEN AGREED WITH B&NES (PMI-007 OPTIONEERING), TO BE DEVELOPED AT DETAILED DESIGN STAGE.

SCHEME EXTENTS AND INTERFACE WITH SVL SCHEME 16 ("OLD MILLS LANE") IS INDICATIVE AND TO BE CONFIRMED AND FINALISED IN DETAILED DESIGN STAGE.

INSET - 8

NOTES

- DO NOT SCALE FROM THIS DRAWING.
- ALL DIMENSIONS ARE IN METRES UNLESS OTHERWISE STATED.
- THIS DRAWING SHALL NOT BE USED FOR CONSTRUCTION PURPOSES.
- LIMITS OF WORK ARE APPROXIMATE AND ARE TO BE AGREED ON SITE WITH THE OVERSEEING ORGANISATION.
- HEALTH AND SAFETY:
IT IS THE CONTRACTOR'S RESPONSIBILITY TO BE AWARE OF ALL STATUTORY UNDERTAKERS' PLANT THAT MAY BE LOCATED WITHIN THE SITE.
- PROPOSED TRAFFIC SIGNS AND ROAD MARKINGS TYPE/COLOURS AND DIMENSIONS SHALL BE IN ACCORDANCE WITH TSRGD 2016 AND SUBSEQUENT AMENDMENTS.
- LIGHTING AND TRAFFIC SIGNAL (IF ANY) PROPOSAL TO BE FINALISED AT DETAILED DESIGN STAGE.
- ALL STREET LIGHTING COLUMNS AND TELEGRAPH POLES WITHIN THE EXTENTS OF THE PROPOSED SUP WILL NEED TO BE RELOCATED. STREET LIGHTING PROVISION TO BE CONFIRMED AT DETAILED DESIGN STAGE.
- POTENTIAL FOR SUP TO BE SEPARATED FROM PRIVATE LAND BY FENCING. TBC AT DETAILED DESIGN STAGE.

KEY

- EXISTING HIGHWAY BOUNDARY
- PROPOSED HALF BATTERED KERB (HB2) (UPSTAND TO MATCH WITH THE EXISTING)
- PROPOSED FLAT TOPPED EDGING (EF)
- PROPOSED ROAD MARKINGS
- PROPOSED SHARED USE PATH
- PROPOSED VERGE
- SITE EXTENTS

SAFETY, HEALTH AND ENVIRONMENTAL INFORMATION

In addition to the hazards/risks normally associated with the types of work detailed on this drawing, note the following significant residual risks (Reference shall also be made to the design hazard log).

Construction	Presence of 11KV electric overhead line
Maintenance / Cleaning	None
Use	None
Decommissioning / Demolition	None

Description	Status	Revision	Drawn	Checked	Reviewed	Authorised	Issue Date

For Public Consultation							
Status	Revision	Drawn	Checked	Reviewed	Authorised	Issue Date	Status
S2	P01	---	---	---	---	30/01/25	S2

FOR INFORMATION

AtkinsRéalis Aztec West
500 Park Avenue
Almondsbury
Bristol
BS32 4RZ
Tel: +44 (0)1454 662000
+44 (0)1454 663333
www.atkinsrealis.com

Copyright © AtkinsRéalis (2025)

Bath & North Somerset Council
Improving People's Lives

Project Title: Somer Valley Links FBC

Drawing Title: GENERAL ARRANGEMENT A362 CYCLING ROUTE (SHEET 9 OF 9)

Drawing Number	Project	Originator	Volume
5230888	- ATR	- HGN	-
CLSV_15	- DR	- CH	- 000009
Location	Type	Role	Number
Original Size: A1	Scale: 1:250	Project Ref. No: 5230888	Sheet: 9 of 9 Rev: P01

THIS DRAWING SHOWS CONCEPT/PRELIMINARY DESIGN PROPOSALS AND DETAILS ARE SUBJECT TO CHANGE

This map is based on Ordnance Survey material with the permission of Ordnance Survey on behalf of the Controller of Her Majesty's Stationary Office. © Crown copyright. Unauthorised reproduction infringes Crown copyright and database rights and may lead to prosecution or civil proceedings. Bath & North East Somerset Council AC2000807488, June 2023