

DO NOT SCALE

Millimetres

0

10

100

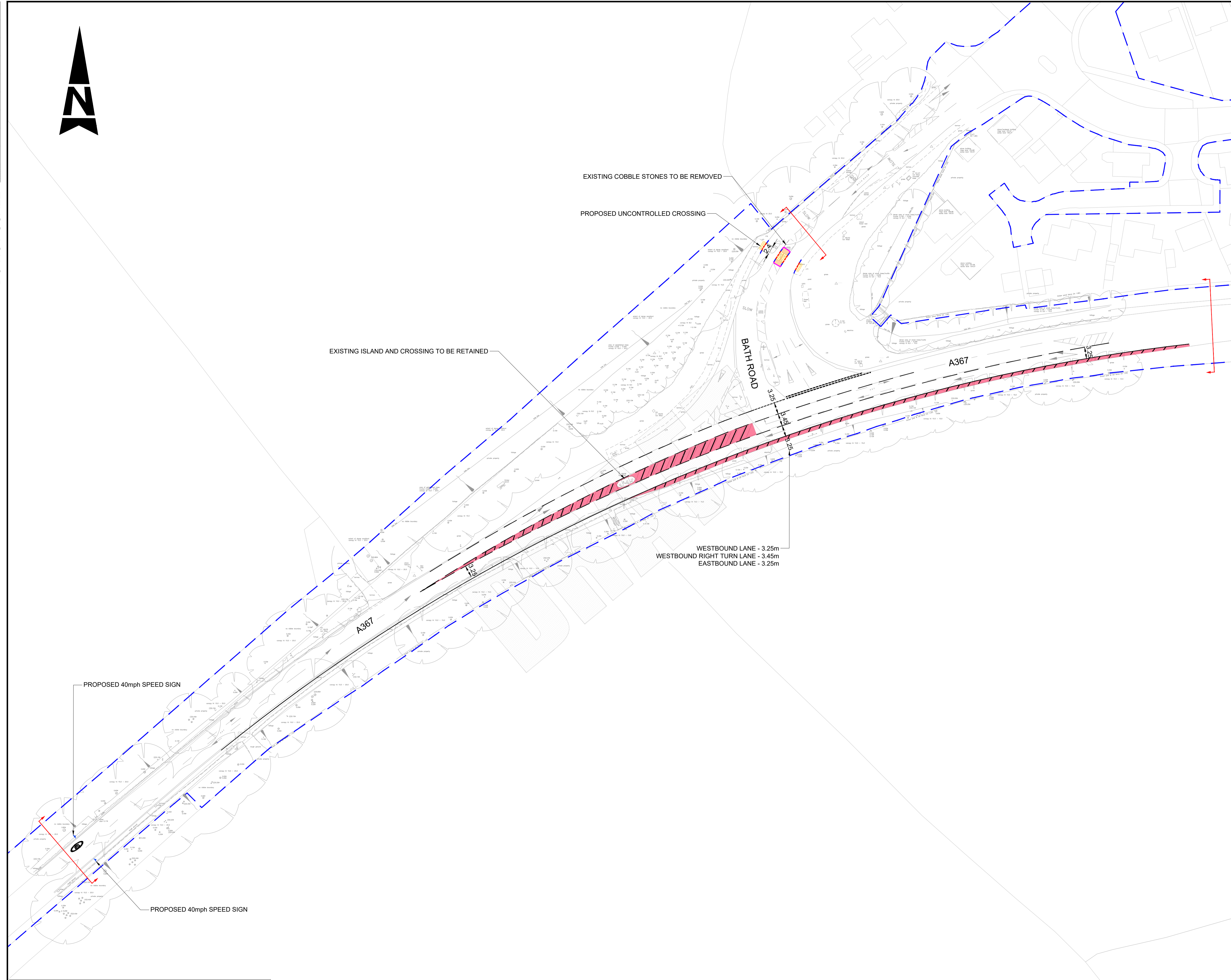
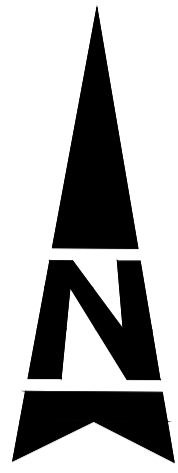

- NOTES**
- DO NOT SCALE FROM THIS DRAWING.
 - ALL DIMENSIONS ARE IN METRES UNLESS OTHERWISE STATED.
 - THIS DRAWING SHALL NOT BE USED FOR CONSTRUCTION PURPOSES.
 - LIMITS OF WORK ARE APPROXIMATE AND ARE TO BE AGREED ON SITE WITH THE OVERSEEING ORGANISATION.
 - HEALTH AND SAFETY:
IT IS THE CONTRACTOR'S RESPONSIBILITY TO BE AWARE OF ALL STATUTORY UNDERTAKERS' PLANT THAT MAY BE LOCATED WITHIN THE SITE.
 - PROPOSED TRAFFIC SIGNS AND ROAD MARKINGS TYPE/COLOURS AND DIMENSIONS SHALL BE IN ACCORDANCE WITH TSRGD 2016 AND SUBSEQUENT AMENDMENTS.
 - LIGHTING AND TRAFFIC SIGNAL (IF ANY) PROPOSAL TO BE FINALISED AT DETAILED DESIGN STAGE.

- KEY**
- EXISTING HIGHWAY BOUNDARY
 - PROPOSED HALF BATTERED KERB (HB2) (UPSTAND 100mm)
 - PROPOSED TRANSITION KERB BETWEEN HB2 & BN
 - PROPOSED BULLNOSE KERB (BN) (UPSTAND 0-6mm)
 - PROPOSED ROAD MARKINGS
 - PROPOSED ISLAND CONSTRUCTION
 - PROPOSED COLORED CARRIAGEWAY RESURFACING
 - PROPOSED BLISTER TACTILE PAVING (BUFF COLOUR)
 - PROPOSED TRAFFIC SIGNS
 - SITE EXTENTS

SAFETY, HEALTH AND ENVIRONMENTAL INFORMATION

In addition to the hazards/risks normally associated with the types of work detailed on this drawing, note the following significant residual risks (Reference shall also be made to the design hazard log).

Construction	Presence of live traffic & live utilities. Presence of soil contamination, asbestos, tar and breaking of concrete not known.
Maintenance / Cleaning	None
Use	None
Decommissioning / Demolition	None

Description	Status	Revision	Drawn	Checked	Reviewed	Authorised	Issue Date
Description	Status	Revision	Drawn	Checked	Reviewed	Authorised	Issue Date
Description	Status	Revision	Drawn	Checked	Reviewed	Authorised	Issue Date
Description	Status	Revision	Drawn	Checked	Reviewed	Authorised	Issue Date
Description	Status	Revision	Drawn	Checked	Reviewed	Authorised	Issue Date

For Public Consultation

Status	Revision	Drawn	Checked	Reviewed	Authorised	Issue Date
S2	P01	---	---	---	---	30/01/2025

Drawing Suitability: **FOR INFORMATION** Status: **S2**

AtkinsRéalis Aztec West
500 Park Avenue
Almondsbury
Bristol
BS32 4RZ
Tel: +44 (0)1454 662000
+44 (0)1454 663333
www.atkinsrealis.com

Copyright © AtkinsRéalis (2025)

Bath & North East Somerset Council
Improving People's Lives

Client: **Somer Valley Links FBC**

Drawing Title: **GENERAL ARRANGEMENT
A367/BATH ROAD JUNCTION,
PEASEDOWN ST. JOHN**

THIS DRAWING SHOWS CONCEPT/PRELIMINARY DESIGN PROPOSALS AND DETAILS ARE SUBJECT TO CHANGE

This map is based on Ordnance Survey material with the permission of Ordnance Survey on behalf of the Controller of Her Majesty's Stationary Office. © Crown copyright. Unauthorised reproduction infringes Crown copyright and database rights and may lead to prosecution or civil proceedings. Bath & North East Somerset Council AC2000807488, June 2023.

Original Size: A1	Scale: 1:500	Project Ref. No: 5230888	Sheet: 1 of 1	Rev: P01
--------------------------	--------------	--------------------------	---------------	-----------------