

Milsom Quarter Broad Street Yards: Design Strategies

Creative Workspaces



What is the Character of the Site?



Approach to Site - Spatial Ingredients / Principles on Plan



How does Bath Integrate Nature in its Urban Fabric?

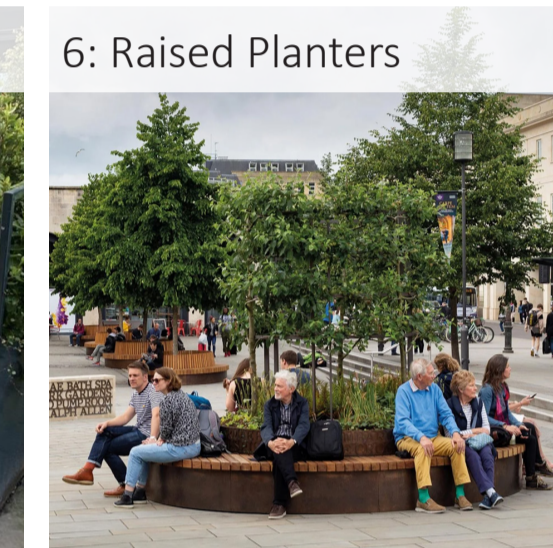
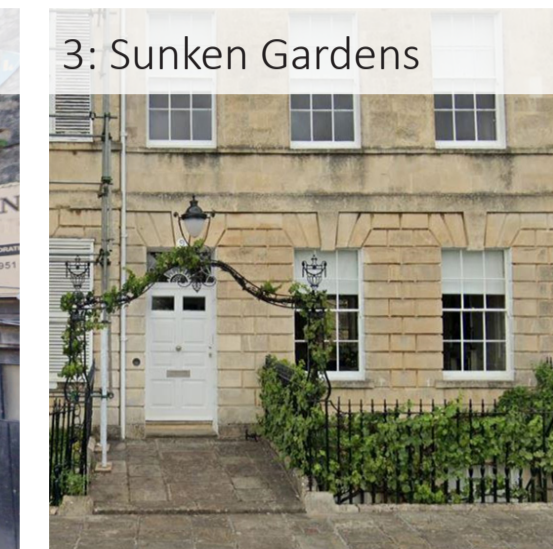
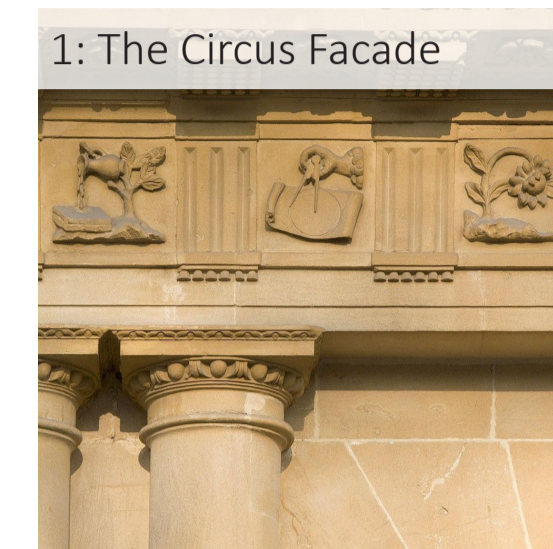

- 1. The Circus Facade**
Elements of the natural world are carved in stone
- 2. Greening of Walls**
Colonised wall planting provides unexpected elements of green
- 3. Sunken Garden**
Georgian basement gardens as secret green oasis
- 4. The Working Mews**
Maker studios occupy spaces for dwelling and socialising
- 5. Parklets**
Raised planters provide screening for seating areas
- 6. Raised Planters**
Movable planter seats allowing changes for different events

Green Intervention Opportunities in the Public Realm: Yards, Alleys and Gardens

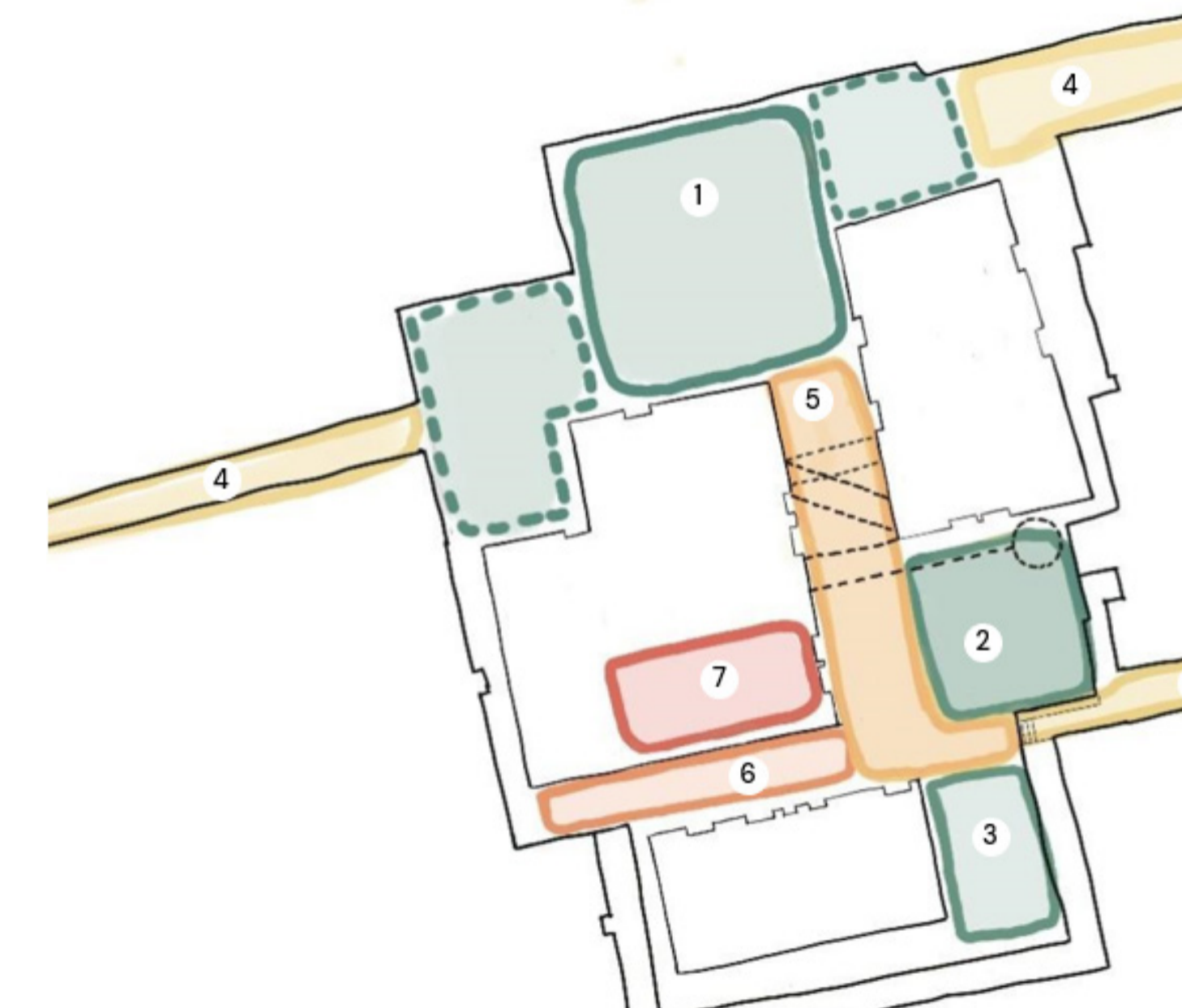

1. Open Yard
2. Green Yard
3. Secret Garden
4. Entrance Alleys
5. Open Alley
6. Makers Alley
7. Roof Terrace

