

DO NOT SCALE

Millimetres

0 10

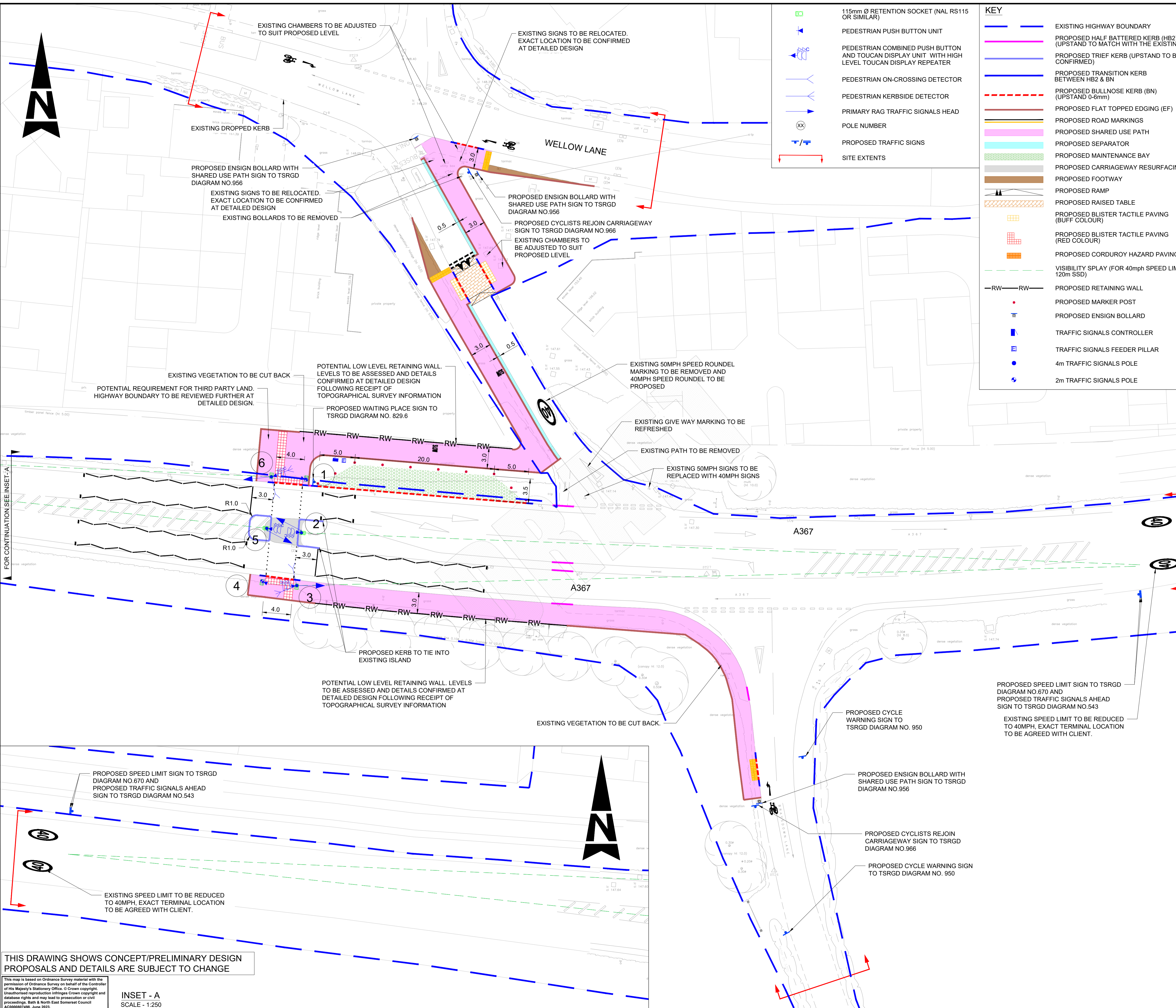

- 115mm Ø RETENTION SOCKET (NAL RS115 OR SIMILAR)
- PEDESTRIAN PUSH BUTTON UNIT
- PEDESTRIAN COMBINED PUSH BUTTON AND TOUCAN DISPLAY UNIT WITH HIGH LEVEL TOUCAN DISPLAY REPEATER
- PEDESTRIAN ON-CROSSING DETECTOR
- PEDESTRIAN KERBSIDE DETECTOR
- PRIMARY RAG TRAFFIC SIGNALS HEAD
- POLE NUMBER
- PROPOSED TRAFFIC SIGNS
- SITE EXTENTS

- KEY**
- EXISTING HIGHWAY BOUNDARY
 - PROPOSED HALF BATTERED KERB (HB2) (UPSTAND TO MATCH WITH THE EXISTING)
 - PROPOSED TRIEF KERB (UPSTAND TO BE CONFIRMED)
 - PROPOSED TRANSITION KERB BETWEEN HB2 & BN
 - PROPOSED BULLNOSE KERB (BN) (UPSTAND 0-6mm)
 - PROPOSED FLAT TOPPED EDGING (EF)
 - PROPOSED ROAD MARKINGS
 - PROPOSED SHARED USE PATH
 - PROPOSED SEPARATOR
 - PROPOSED MAINTENANCE BAY
 - PROPOSED CARRIAGEWAY RESURFACING
 - PROPOSED FOOTWAY
 - PROPOSED RAMP
 - PROPOSED RAISED TABLE
 - PROPOSED BLISTER TACTILE PAVING (BUFF COLOUR)
 - PROPOSED BLISTER TACTILE PAVING (RED COLOUR)
 - PROPOSED CORDUROY HAZARD PAVING
 - VISIBILITY SPLAY (FOR 40mph SPEED LIMIT, 120m SSD)
 - PROPOSED RETAINING WALL
 - PROPOSED MARKER POST
 - PROPOSED ENSIGN BOLLARD
 - TRAFFIC SIGNALS CONTROLLER
 - TRAFFIC SIGNALS FEEDER PILLAR
 - 4m TRAFFIC SIGNALS POLE
 - 2m TRAFFIC SIGNALS POLE

- NOTES**
- DO NOT SCALE FROM THIS DRAWING.
 - ALL DIMENSIONS ARE IN METRES UNLESS OTHERWISE STATED.
 - THIS DRAWING SHALL NOT BE USED FOR CONSTRUCTION PURPOSES.
 - LIMITS OF WORK ARE APPROXIMATE AND ARE TO BE AGREED ON SITE WITH THE OVERSEEING ORGANISATION.
 - HEALTH AND SAFETY: IT IS THE CONTRACTOR'S RESPONSIBILITY TO BE AWARE OF ALL STATUTORY UNDERTAKERS' PLANT THAT MAY BE LOCATED WITHIN THE SITE.
 - PROPOSED TRAFFIC SIGNS AND ROAD MARKINGS TYPE/COLOURS AND DIMENSIONS SHALL BE IN ACCORDANCE WITH TSRGD 2016 AND SUBSEQUENT AMENDMENTS.
 - LIGHTING AND TRAFFIC SIGNAL (IF ANY) PROPOSAL TO BE FINALISED AT DETAILED DESIGN STAGE.

SAFETY, HEALTH AND ENVIRONMENTAL INFORMATION

In addition to the hazards/risks normally associated with the types of work detailed on this drawing, note the following significant residual risks (Reference shall also be made to the design hazard log).

Construction	Presence of live traffic & live utilities.
Use	Presence of soil contamination, asbestos, tar and breaking of concrete not known.
Decommissioning / Demolition	None

Description	Status	Revision	Drawn	Checked	Reviewed	Authorised	Issue Date

For Public Consultation							Status
Status	Revision	Drawn	Checked	Reviewed	Authorised	Issue Date	
S2	P01	PJ	RM	SC	---	30/01/25	S2

FOR INFORMATION

AtkinsRéalis Aztec West
500 Park Avenue
Almondsbury
Bristol
BS32 4RZ
Tel: +44 (0)1454 662000
+44 (0)1454 663333
www.atkinsrealis.com

Copyright © AtkinsRéalis (2025)

Bath & North Somerset Council
Improving People's Lives

Project Title: Somer Valley Links FBC

Drawing Title: GENERAL ARRANGEMENT IMPROVED ACCESS TO NC24 FROM PEASEDOWN ST. JOHN (SHOSCOMBE) (SHEET 1 OF 2)

Original Size: A1	Scale: 1:250	Project Ref. No: 5230888	Sheet: 1 of 2	Rev: P01
-------------------	--------------	--------------------------	---------------	----------

THIS DRAWING SHOWS CONCEPT/PRELIMINARY DESIGN PROPOSALS AND DETAILS ARE SUBJECT TO CHANGE

This map is based on Ordnance Survey material with the permission of Ordnance Survey on behalf of the Controller of Her Majesty's Stationary Office. © Crown copyright. Unauthorised reproduction infringes Crown copyright and database rights and may lead to prosecution or civil proceedings. Bath & North East Somerset Council AC2000807488, June 2023

INSET - A
SCALE - 1:250

DO NOT SCALE

Millimetres

0 10

Plotted: 30/01/2025 16:02:03 By: YADA4119

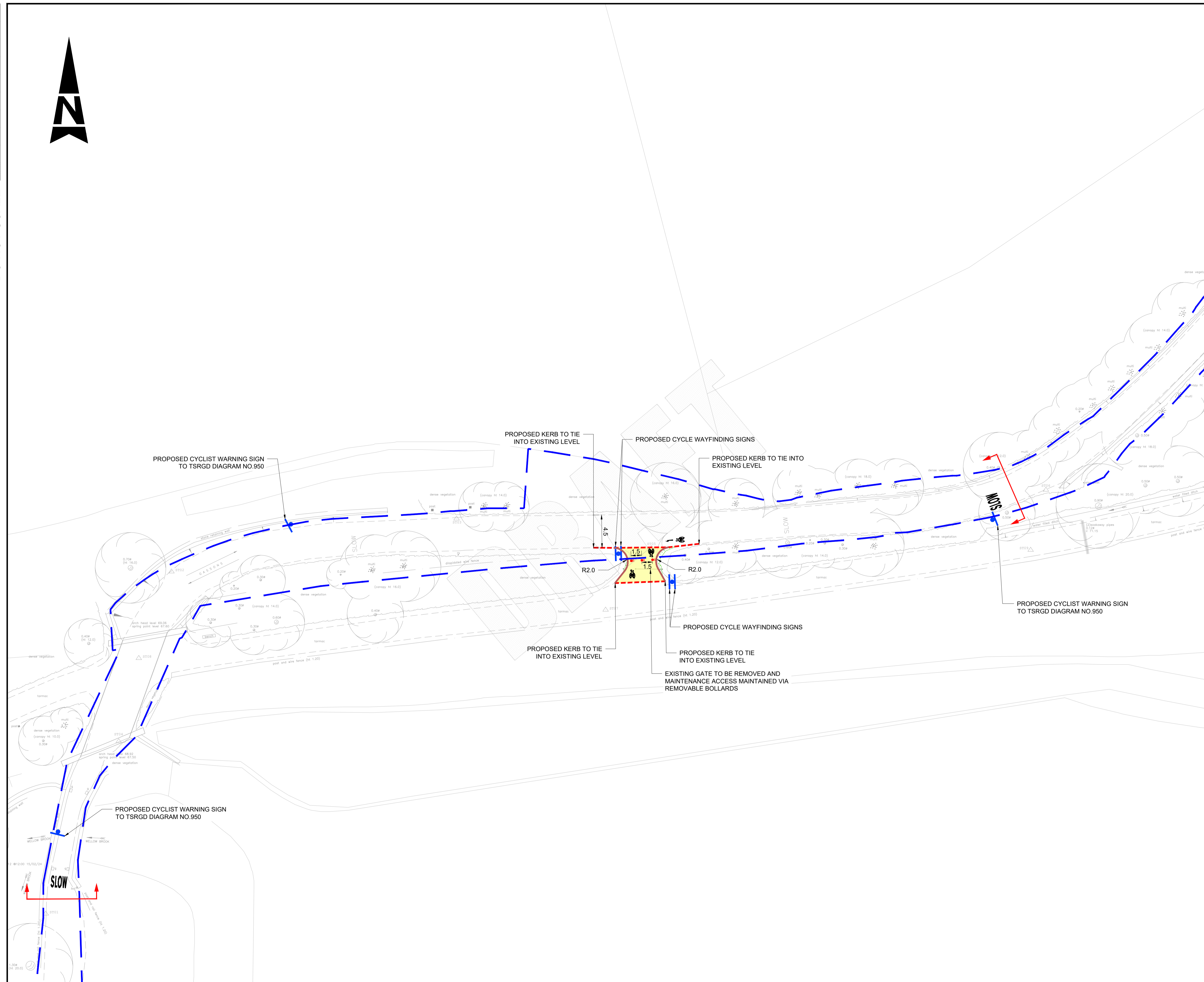
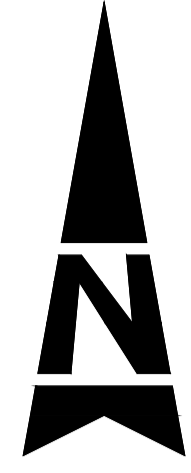

- NOTES**
- DO NOT SCALE FROM THIS DRAWING.
 - ALL DIMENSIONS ARE IN METRES UNLESS OTHERWISE STATED.
 - THIS DRAWING SHALL NOT BE USED FOR CONSTRUCTION PURPOSES.
 - LIMITS OF WORK ARE APPROXIMATE AND ARE TO BE AGREED ON SITE WITH THE OVERSEEING ORGANISATION.
 - HEALTH AND SAFETY:
IT IS THE CONTRACTOR'S RESPONSIBILITY TO BE AWARE OF ALL STATUTORY UNDERTAKERS' PLANT THAT MAY BE LOCATED WITHIN THE SITE.
 - PROPOSED TRAFFIC SIGNS AND ROAD MARKINGS TYPE/COLOURS AND DIMENSIONS SHALL BE IN ACCORDANCE WITH TSRGD 2016 AND SUBSEQUENT AMENDMENTS.
 - LIGHTING AND TRAFFIC SIGNAL (IF ANY) PROPOSAL TO BE FINALISED AT DETAILED DESIGN STAGE.

KEY

	EXISTING HIGHWAY BOUNDARY
	PROPOSED FLAT TOPPED EDGING (EF)
	PROPOSED BULLNOSE KERB (BN) (UPSTAND 0-6mm)
	PROPOSED ROAD MARKINGS
	PROPOSED CYCLEWAY
	PROPOSED VERGE
	REMOVABLE BOLLARDS
	PROPOSED TRAFFIC SIGNS
	SITE EXTENTS

SAFETY, HEALTH AND ENVIRONMENTAL INFORMATION

In addition to the hazards/risks normally associated with the types of work detailed on this drawing, note the following significant residual risks (Reference shall also be made to the design hazard log).

Construction	Presence of live traffic & live utilities.
	Presence of soil contamination, asbestos, tar and breaking of concrete not known.
Maintenance / Cleaning	None
Use	None
Decommissioning / Demolition	None

Description						
Status	Revision	Drawn	Checked	Reviewed	Authorised	Issue Date
Description						
Status	Revision	Drawn	Checked	Reviewed	Authorised	Issue Date
Description						
Status	Revision	Drawn	Checked	Reviewed	Authorised	Issue Date
Description						
Status	Revision	Drawn	Checked	Reviewed	Authorised	Issue Date

For Public Consultation

Status	Revision	Drawn	Checked	Reviewed	Authorised	Issue Date
S2	P01	PJ	RM	SC	---	30/01/25
Drawing Suitability						Status
FOR INFORMATION						S2

AtkinsRéalis Aztec West
500 Park Avenue
Almondsbury
Bristol
BS32 4RZ
Tel: +44 (0)1454 662000
+44 (0)1454 663333
www.atkinsrealis.com

Copyright © AtkinsRéalis (2025)

Bath & North East Somerset Council
Improving People's Lives

Project Title
Somer Valley Links FBC

Drawing Title
**GENERAL ARRANGEMENT
IMPROVED ACCESS TO NCN24 FROM
PEASEDOWN ST. JOHN (SHOSCOMBE)
(SHEET 2 OF 2)**

Project	Originator	Volume		
5230888	ATR	HGN -		
SN24_17	DR	CH - 000002		
Location	Type	Role	Number	
A1	1:250	5230888	2 of 2	
Original Size	Scale	Project Ref. No.	Sheet	Rev.
A1	1:250	5230888	2 of 2	P01

This map is based on Ordnance Survey material with the permission of Ordnance Survey on behalf of the Controller of the Major's Stationary Office. © Crown copyright. Unauthorised reproduction infringes Crown copyright and database rights and may lead to prosecution or civil proceedings. Bath & North East Somerset Council AC200807488, June 2023.

THIS DRAWING SHOWS CONCEPT/PRELIMINARY DESIGN PROPOSALS AND DETAILS ARE SUBJECT TO CHANGE