

DO NOT SCALE

Millimetres

0 10 100

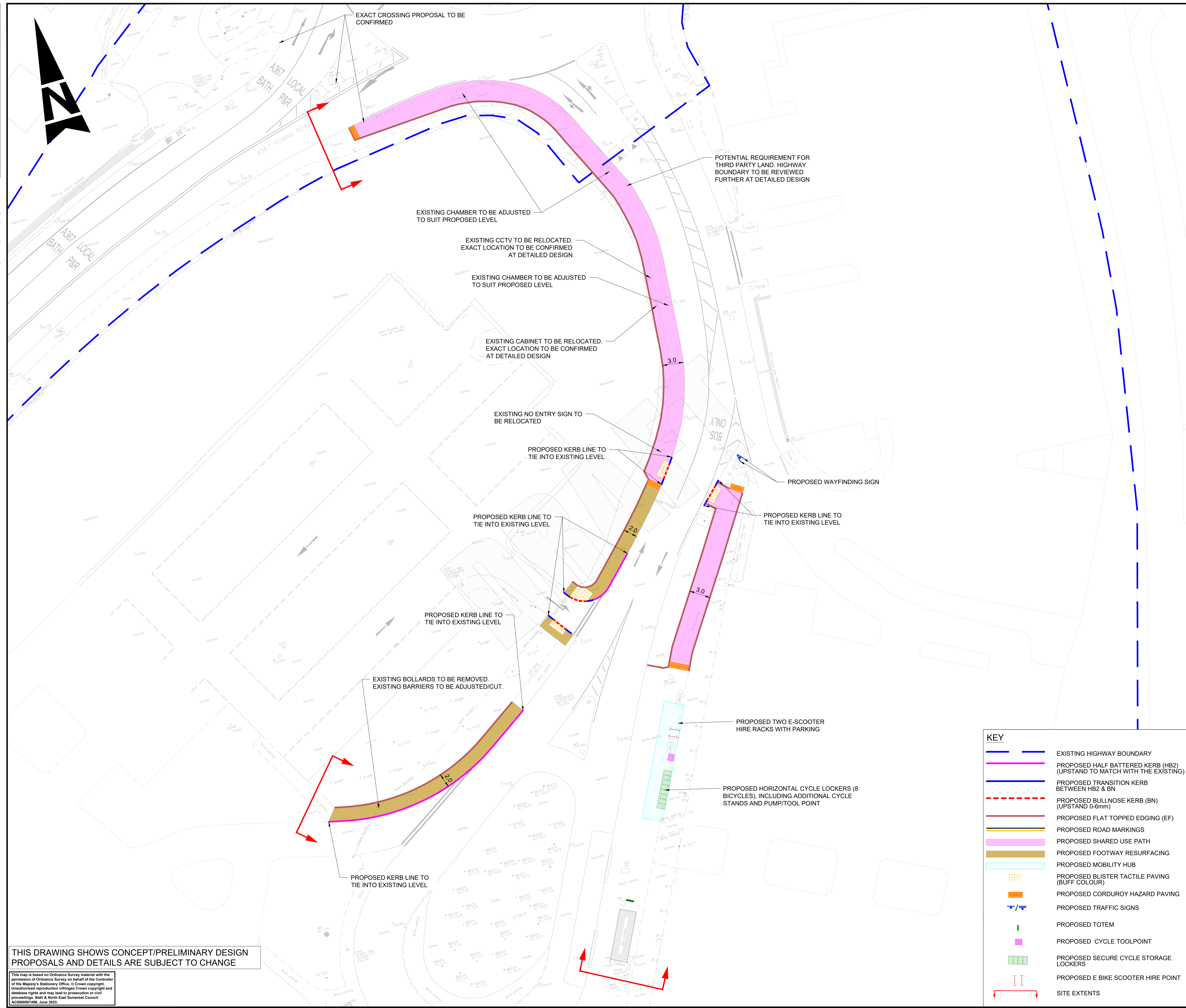
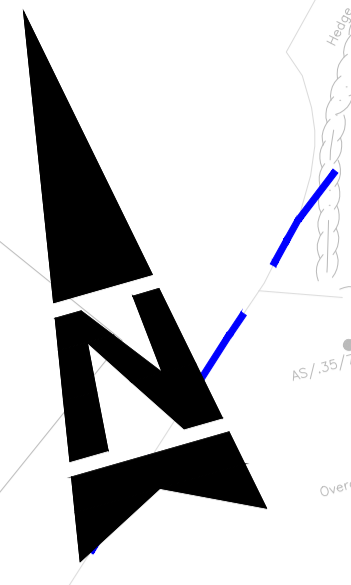

- NOTES**
- DO NOT SCALE FROM THIS DRAWING.
  - ALL DIMENSIONS ARE IN METRES UNLESS OTHERWISE STATED.
  - THIS DRAWING SHALL NOT BE USED FOR CONSTRUCTION PURPOSES.
  - LIMITS OF WORK ARE APPROXIMATE AND ARE TO BE AGREED ON SITE WITH THE OVERSEEING ORGANISATION.
  - HEALTH AND SAFETY:  
IT IS THE CONTRACTOR'S RESPONSIBILITY TO BE AWARE OF ALL STATUTORY UNDERTAKERS' PLANT THAT MAY BE LOCATED WITHIN THE SITE.
  - PROPOSED TRAFFIC SIGNS AND ROAD MARKINGS TYPE/COLOURS AND DIMENSIONS SHALL BE IN ACCORDANCE WITH TSRGD 2016 AND SUBSEQUENT AMENDMENTS.
  - LIGHTING AND TRAFFIC SIGNAL (IF ANY) PROPOSAL TO BE FINALISED AT DETAILED DESIGN STAGE.
  - CCTV REQUIREMENTS TO BE REVIEWED AT DETAILED DESIGN.
  - EXISTING MANHOLES AND CHAMBERS TO BE ADJUSTED AS NEEDED TO SUIT PROPOSED LEVELS.
  - EXACT LOCATION AND SPECIFICATION OF MOBILITY HUB INFRASTRUCTURE TO BE CONFIRMED AT DETAILED DESIGN.

**SAFETY, HEALTH AND ENVIRONMENTAL INFORMATION**

In addition to the hazards/risks normally associated with the types of work detailed on this drawing, note the following significant residual risks (Reference shall also be made to the design hazard log).

Construction	Presence of 11KV electric overhead line
Maintenance / Cleaning	None
Use	None
Decommissioning / Demolition	None

Status	Revision	Drawn	Checked	Reviewed	Authorised	Issue Date

Status	Revision	Drawn	Checked	Reviewed	Authorised	Issue Date
S2	P01	PJ	RM	SC	---	30/01/25

**FOR INFORMATION**

S2

**AtkinsRéalis** Aztec West  
500 Park Avenue  
Almondsbury  
Bristol  
BS32 4RZ  
Tel: +44 (0)1454 662000  
+44 (0)1454 663333  
www.atkinsrealis.com

Copyright © AtkinsRéalis (2025)

**Bath & North East Somerset Council**

Improving People's Lives

Project Title: Somer Valley Links FBC

Drawing Title: GENERAL ARRANGEMENT MULTIMODAL PROVISIONS AT ODD DOWN PARK AND RIDE

Project Number	5230888	Originator	ATR	Volume	HGN -
Location	ODPR_07	Type	DR	Role	CH - 000001
Original Size	A1	Scale	1:250	Project Ref. No.	5230888
Plotted	30/01/2025 12:14:47	By:	YADA4119	Sheet	1 of 1
				Rev.	P01

**KEY**

- EXISTING HIGHWAY BOUNDARY
- PROPOSED HALF BATTERED KERB (HB2) (UPSTAND TO MATCH WITH THE EXISTING)
- PROPOSED TRANSITION KERB BETWEEN HB2 & BN
- PROPOSED BULLNOSE KERB (BN) (UPSTAND 0-6mm)
- PROPOSED FLAT TOPPED EDGING (EF)
- PROPOSED ROAD MARKINGS
- PROPOSED SHARED USE PATH
- PROPOSED FOOTWAY RESURFACING
- PROPOSED MOBILITY HUB
- PROPOSED BLISTER TACTILE PAVING (BUFF COLOUR)
- PROPOSED CORDUROY HAZARD PAVING
- PROPOSED TRAFFIC SIGNS
- PROPOSED TOTEM
- PROPOSED CYCLE TOOLPOINT
- PROPOSED SECURE CYCLE STORAGE LOCKERS
- PROPOSED E BIKE SCOOTER HIRE POINT
- SITE EXTENTS

THIS DRAWING SHOWS CONCEPT/PRELIMINARY DESIGN PROPOSALS AND DETAILS ARE SUBJECT TO CHANGE

This map is based on Ordnance Survey material with the permission of Ordnance Survey on behalf of the Controller of the Majesty's Stationery Office. © Crown copyright. Unauthorised reproduction infringes Crown copyright and database rights and may lead to prosecution or civil proceedings. Bath & North East Somerset Council AC200807488, June 2023