

DO NOT SCALE

Millimetres

0 10

100

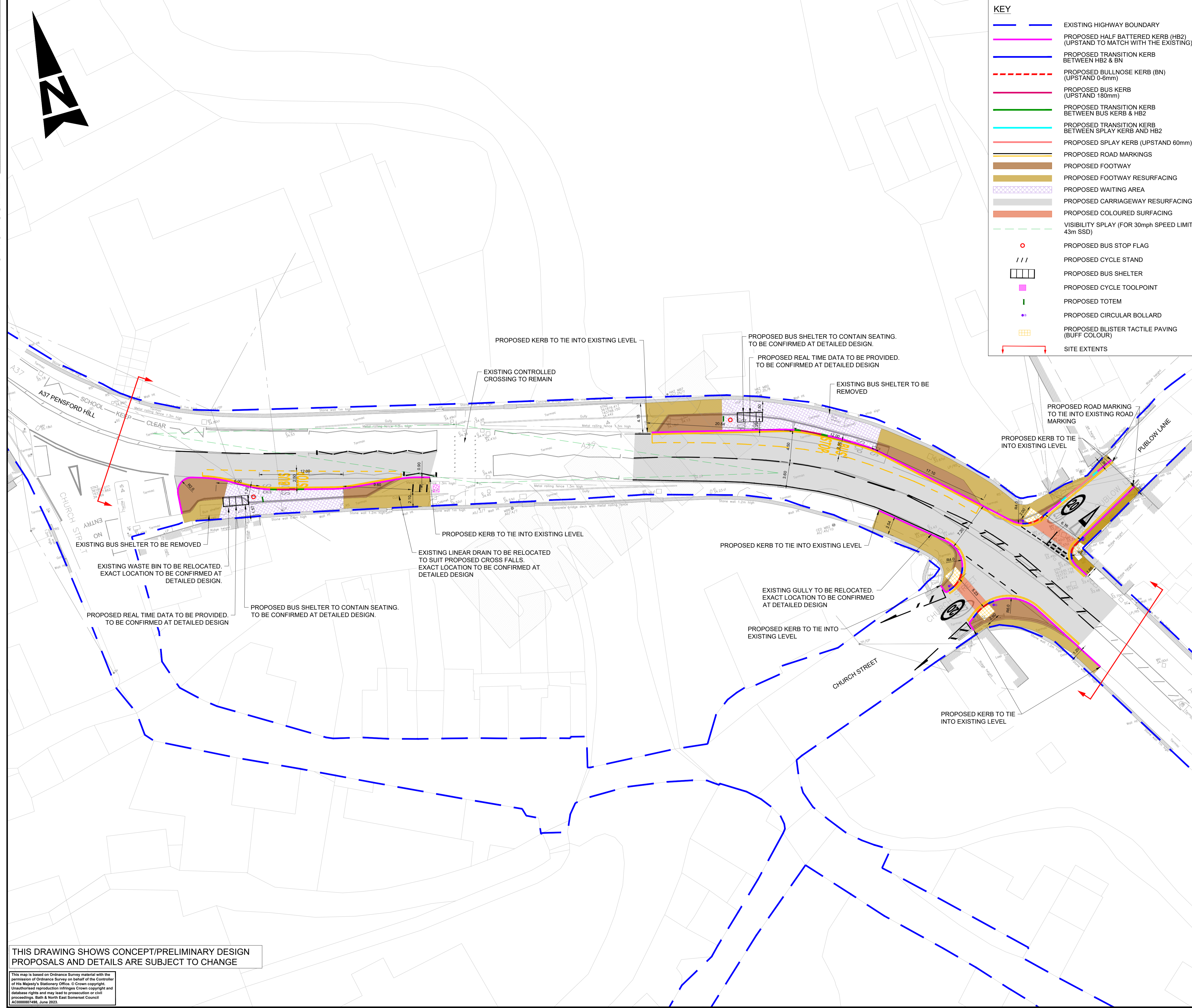
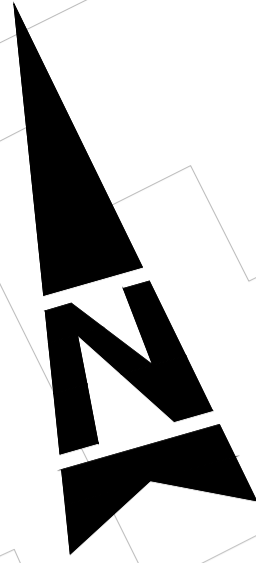

**KEY**

	EXISTING HIGHWAY BOUNDARY
	PROPOSED HALF BATTERED KERB (HB2) (UPSTAND TO MATCH WITH THE EXISTING)
	PROPOSED TRANSITION KERB BETWEEN HB2 & BN
	PROPOSED BULLNOSE KERB (BN) (UPSTAND 0-6mm)
	PROPOSED BUS KERB (UPSTAND 180mm)
	PROPOSED TRANSITION KERB BETWEEN BUS KERB & HB2
	PROPOSED TRANSITION KERB BETWEEN SPLAY KERB AND HB2
	PROPOSED SPLAY KERB (UPSTAND 60mm)
	PROPOSED ROAD MARKINGS
	PROPOSED FOOTWAY
	PROPOSED FOOTWAY RESURFACING
	PROPOSED WAITING AREA
	PROPOSED CARRIAGEWAY RESURFACING
	PROPOSED COLOURED SURFACING
	VISIBILITY SPLAY (FOR 30mph SPEED LIMIT, 43m SSD)
	PROPOSED BUS STOP FLAG
	PROPOSED CYCLE STAND
	PROPOSED BUS SHELTER
	PROPOSED CYCLE TOOLPOINT
	PROPOSED TOTEM
	PROPOSED CIRCULAR BOLLARD
	PROPOSED BLISTER TACTILE PAVING (BUFF COLOUR)
	SITE EXTENTS

- NOTES**
- DO NOT SCALE FROM THIS DRAWING.
  - ALL DIMENSIONS ARE IN METRES UNLESS OTHERWISE STATED.
  - THIS DRAWING SHALL NOT BE USED FOR CONSTRUCTION PURPOSES.
  - LIMITS OF WORK ARE APPROXIMATE AND ARE TO BE AGREED ON SITE WITH THE OVERSEEING ORGANISATION.
  - HEALTH AND SAFETY: IT IS THE CONTRACTOR'S RESPONSIBILITY TO BE AWARE OF ALL STATUTORY UNDERTAKERS' PLANT THAT MAY BE LOCATED WITHIN THE SITE.
  - PROPOSED TRAFFIC SIGNS AND ROAD MARKINGS TYPE/COLOURS AND DIMENSIONS SHALL BE IN ACCORDANCE WITH TSRGD 2016 AND SUBSEQUENT AMENDMENTS.
  - LIGHTING AND TRAFFIC SIGNAL (IF ANY) PROPOSAL TO BE FINALISED AT DETAILED DESIGN STAGE.
  - EXISTING MANHOLES AND CHAMBERS TO BE ADJUSTED AS NEEDED TO SUIT PROPOSED LEVELS.
  - EXACT LOCATION AND SPECIFICATION OF MOBILITY HUB INFRASTRUCTURE TO BE CONFIRMED AT DETAILED DESIGN.

**SAFETY, HEALTH AND ENVIRONMENTAL INFORMATION**

In addition to the hazards/risks normally associated with the types of work detailed on this drawing, note the following significant residual risks (Reference shall also be made to the design hazard log).

Construction
Presence of live traffic & live utilities.
Presence of soil contamination, asbestos, tar and breaking of concrete not known
Maintenance / Cleaning
None

Use
None

Decommissioning / Demolition
None

Description
Status
Revision
Drawn
Checked
Reviewed
Authorised
Issue Date

Description
Status
Revision
Drawn
Checked
Reviewed
Authorised
Issue Date

Description
Status
Revision
Drawn
Checked
Reviewed
Authorised
Issue Date

Description
Status
Revision
Drawn
Checked
Reviewed
Authorised
Issue Date

Description
Status
Revision
Drawn
Checked
Reviewed
Authorised
Issue Date

For Public Consultation							
Status	Revision	Drawn	Checked	Reviewed	Authorised	Issue Date	
S2	P01	PJ	RM	SC	---	30/01/25	

Drawing Suitability	FOR INFORMATION	Status
		S2

**AtkinsRéalis** Aztec West  
500 Park Avenue  
Almondsbury  
Bristol  
BS32 4RZ  
Tel: +44 (0)1454 662000  
+44 (0)1454 663333  
www.atkinsrealis.com

Copyright © AtkinsRéalis (2025)

**Bath & North Somerset Council**  
Improving People's Lives

Project Title: Somer Valley Links FBC

Drawing Title: GENERAL ARRANGEMENT PENSFORD MOBILITY HUB

THIS DRAWING SHOWS CONCEPT/PRELIMINARY DESIGN PROPOSALS AND DETAILS ARE SUBJECT TO CHANGE

This map is based on Ordnance Survey material with the permission of Ordnance Survey on behalf of the Controller of His Majesty's Stationary Office. © Crown copyright. Unauthorised reproduction infringes Crown copyright and database rights and may lead to prosecution or civil proceedings. Bath & North East Somerset Council AC2000807488, June 2023

Drawing Number	Project	Originator	Volume
5230888	-	ATR	- HGN -
Location		Type	Role
PENS_01		- DR - CH -	000001
Original Size	Scale	Project Ref. No.	Sheet
A1	1:250	5230888	1 of 1
Rev.	Rev.	Rev.	Rev.
			P01