

DO NOT SCALE

Millimetres

0 10 100

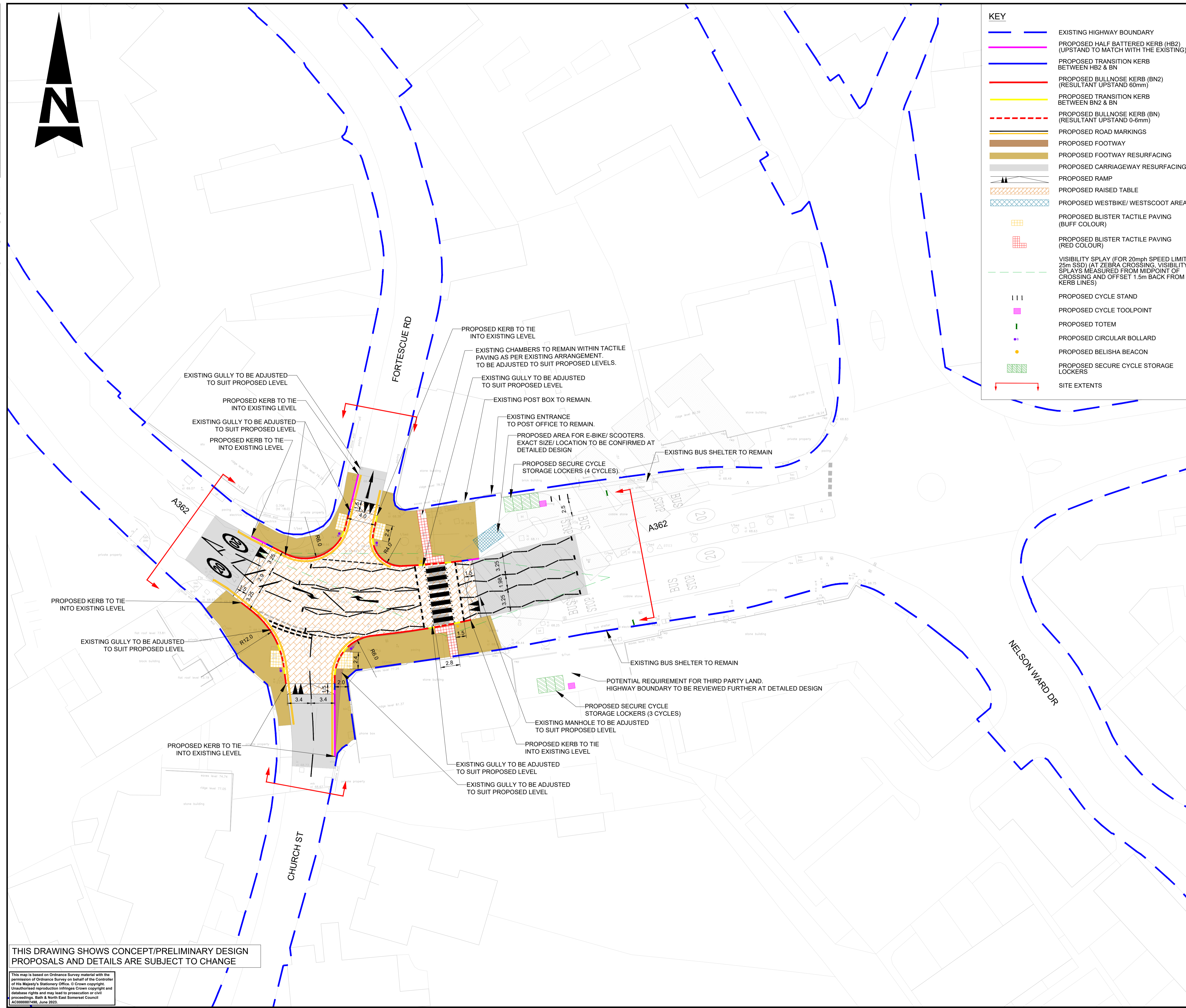
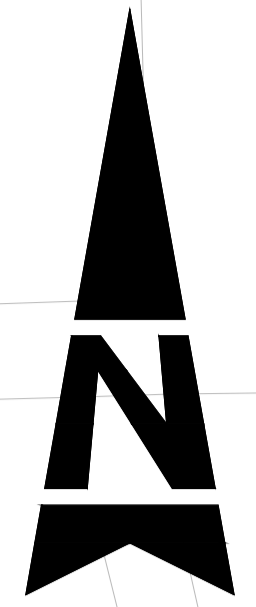

KEY

- EXISTING HIGHWAY BOUNDARY
- PROPOSED HALF BATTERED KERB (HB2) (UPSTAND TO MATCH WITH THE EXISTING)
- PROPOSED TRANSITION KERB BETWEEN HB2 & BN
- PROPOSED BULLNOSE KERB (BN2) (RESULTANT UPSTAND 60mm)
- PROPOSED TRANSITION KERB BETWEEN BN2 & BN
- PROPOSED BULLNOSE KERB (BN) (RESULTANT UPSTAND 0-6mm)
- PROPOSED ROAD MARKINGS
- PROPOSED FOOTWAY
- PROPOSED FOOTWAY RESURFACING
- PROPOSED CARRIAGEWAY RESURFACING
- PROPOSED RAMP
- PROPOSED RAISED TABLE
- PROPOSED WESTBIKE/ WESTSCOOT AREA
- PROPOSED BLISTER TACTILE PAVING (BUFF COLOUR)
- PROPOSED BLISTER TACTILE PAVING (RED COLOUR)
- VISIBILITY SPLAY (FOR 20mph SPEED LIMIT, 25m SSD) (AT ZEBRA CROSSING, VISIBILITY SPLAYS MEASURED FROM MIDPOINT OF CROSSING AND OFFSET 1.5m BACK FROM KERB LINES)
- PROPOSED CYCLE STAND
- PROPOSED CYCLE TOOLPOINT
- PROPOSED TOTEM
- PROPOSED CIRCULAR BOLLARD
- PROPOSED BELISHA BEACON
- PROPOSED SECURE CYCLE STORAGE LOCKERS
- SITE EXTENTS

- NOTES**
1. DO NOT SCALE FROM THIS DRAWING.
 2. ALL DIMENSIONS ARE IN METRES UNLESS OTHERWISE STATED.
 3. THIS DRAWING SHALL NOT BE USED FOR CONSTRUCTION PURPOSES.
 4. LIMITS OF WORK ARE APPROXIMATE AND ARE TO BE AGREED ON SITE WITH THE OVERSEEING ORGANISATION.
 5. HEALTH AND SAFETY: IT IS THE CONTRACTOR'S RESPONSIBILITY TO BE AWARE OF ALL STATUTORY UNDERTAKERS' PLANT THAT MAY BE LOCATED WITHIN THE SITE.
 6. PROPOSED TRAFFIC SIGNS AND ROAD MARKINGS TYPE/COLOURS AND DIMENSIONS SHALL BE IN ACCORDANCE WITH TSRGD 2016 AND SUBSEQUENT AMENDMENTS.
 7. LIGHTING AND TRAFFIC SIGNAL (IF ANY) PROPOSAL TO BE FINALISED AT DETAILED DESIGN STAGE.
 8. EXISTING MANHOLES AND CHAMBERS TO BE ADJUSTED AS NEEDED TO SUIT PROPOSED LEVELS.
 9. EXACT LOCATION AND SPECIFICATION OF MOBILITY HUB INFRASTRUCTURE TO BE CONFIRMED AT DETAILED DESIGN.

SAFETY, HEALTH AND ENVIRONMENTAL INFORMATION

In addition to the hazards/risks normally associated with the types of work detailed on this drawing, note the following significant residual risks (Reference shall also be made to the design hazard log).

Construction
Presence of live traffic & live utilities.
Presence of soil contamination, asbestos, tar and breaking of concrete not known.
Maintenance / Cleaning
None
Use
None
Decommissioning / Demolition
None

Description						
Status	Revision	Drawn	Checked	Reviewed	Authorised	Issue Date
Description						
Status	Revision	Drawn	Checked	Reviewed	Authorised	Issue Date
Description						
Status	Revision	Drawn	Checked	Reviewed	Authorised	Issue Date
Description						
Status	Revision	Drawn	Checked	Reviewed	Authorised	Issue Date

For Public Consultation						
Status	Revision	Drawn	Checked	Reviewed	Authorised	Issue Date
S2	P01	PJ	RM	SC	---	30/01/25
Drawing Suitability	FOR INFORMATION					Status
						S2

AtkinsRéalis Aztec West
500 Park Avenue
Almondsbury
Bristol
BS32 4RZ
Tel: +44 (0)1454 662000
+44 (0)1454 663333
www.atkinsrealis.com

Copyright © AtkinsRéalis (2025)

Bath & North East Somerset Council

Improving People's Lives

Project Title: Somer Valley Links FBC

Drawing Title: GENERAL ARRANGEMENT RADSTOCK MOBILITY HUB

Original Size: A1	Scale: 1:250	Project Ref. No: 5230888	Sheet: 1 of 1	Rev: P01
-------------------	--------------	--------------------------	---------------	----------

THIS DRAWING SHOWS CONCEPT/PRELIMINARY DESIGN PROPOSALS AND DETAILS ARE SUBJECT TO CHANGE

This map is based on Ordnance Survey material with the permission of Ordnance Survey on behalf of the Controller of the Major's Stationary Office. © Crown copyright. Unauthorised reproduction infringes Crown copyright and database rights and may lead to prosecution or civil proceedings. Bath & North East Somerset Council AC200807488, June 2023