

FOR INSET 2 REFER TO
DRAWING:
674726.BP.41/011
INSET 2

FOR INSET 1 REFER TO
DRAWINGS:
674726.BP.41/008
674726.BP.41/009
674726.BP.41/010

Rev	By	Chkd	Apprvd	Date	Description



CH2M
1 The Square Temple Quay Bristol BS1 6DG
Tel +44 (0)117 910 2580 Fax +44 (0)117 910 2581
www.ch2m.com



Project
FEASIBILITY STUDY

Drawing
**WP2
OPTION 1 VARIANTS
KEY PLAN**

Drawn by: AH	Date: 22.01.18
Checked by: AS	Date:
Approved by: DL	Date:

Drawing No.	Revision
674726.BP.41/001	-

Drawing Scale: NTS @ A1

This map is based on Ordnance Survey material with the permission of the Controller of Her Majesty's Stationery Office Crown Copyright. Unauthorised reproduction infringes Crown Copyright and may lead to prosecution or civil proceedings. BATH AND NORTH EAST SOMERSET COUNCIL Licence No. 100023334

WORK IN PROGRESS

A4 BATH ROAD

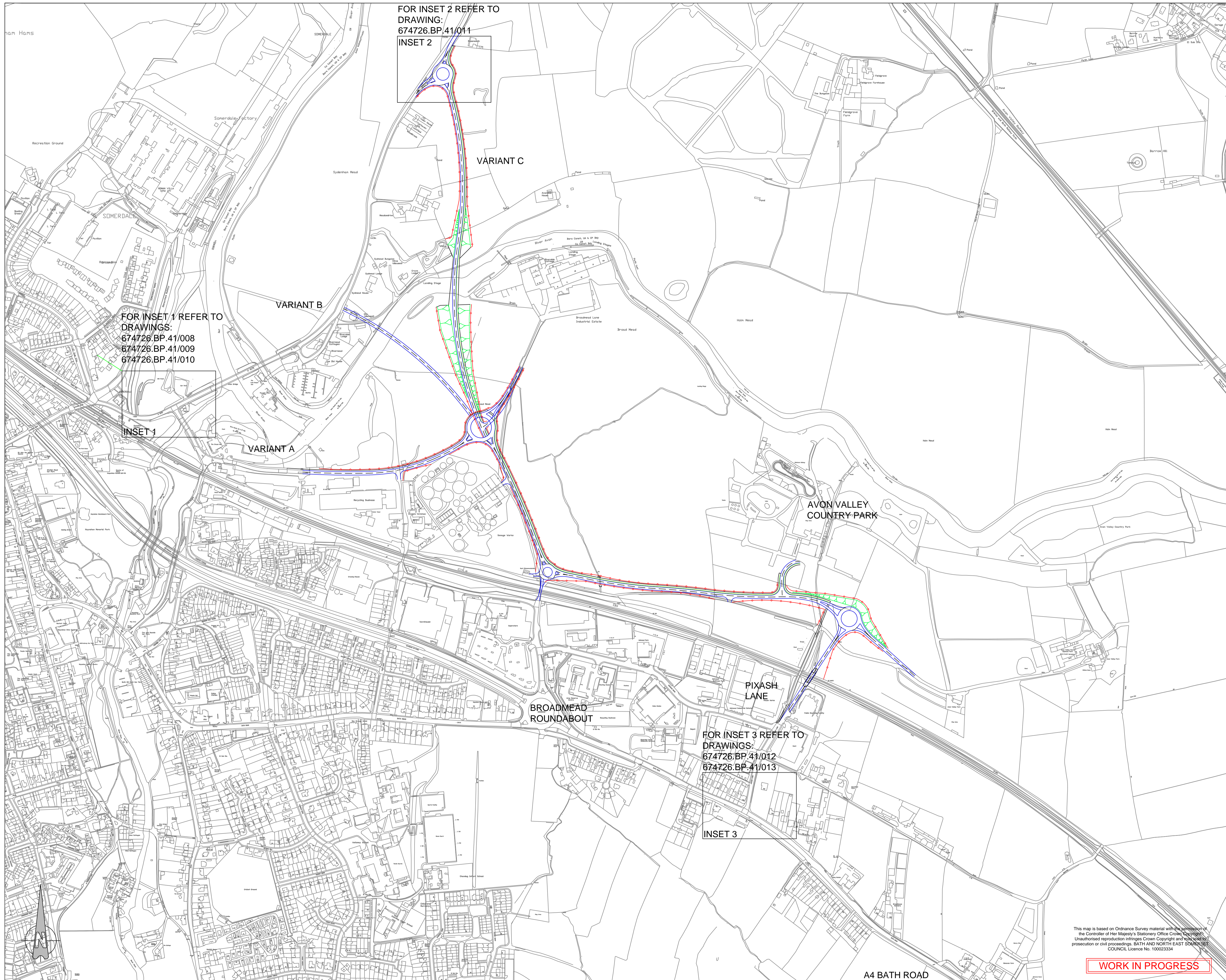

FOR INSET 2 REFER TO
DRAWING:
674726.BP.41/011
INSET 2

FOR INSET 1 REFER TO
DRAWINGS:
674726.BP.41/008
674726.BP.41/009
674726.BP.41/010

FOR INSET 3 REFER TO
DRAWINGS:
674726.BP.41/012
674726.BP.41/013

Rev	By	Chkd	Apprvd	Date	Description

WEST OF ENGLAND
Combined Authority

CH2M
1 The Square Temple Quay Bristol BS1 6DG
Tel +44 (0) 117 910 2580 Fax +44 (0) 117 910 2581
www.ch2m.com

ch2m

Project
FEASIBILITY STUDY

Drawing
**WP2
OPTION 2 VARIANTS
KEY PLAN**

Drawn by: AH Date: 22.01.18

Checked by: AS Date:

Approved by: DL Date:

Drawing No. Revision

674726.BP.41/002 -

This map is based on Ordnance Survey material with the permission of the Controller of Her Majesty's Stationery Office Crown Copyright. Unauthorised reproduction infringes Crown Copyright and may lead to prosecution or civil proceedings. BATH AND NORTH EAST SOMERSET COUNCIL Licence No. 100023334

WORK IN PROGRESS

A4 BATH ROAD

Drawing Scale: NTS @ A1

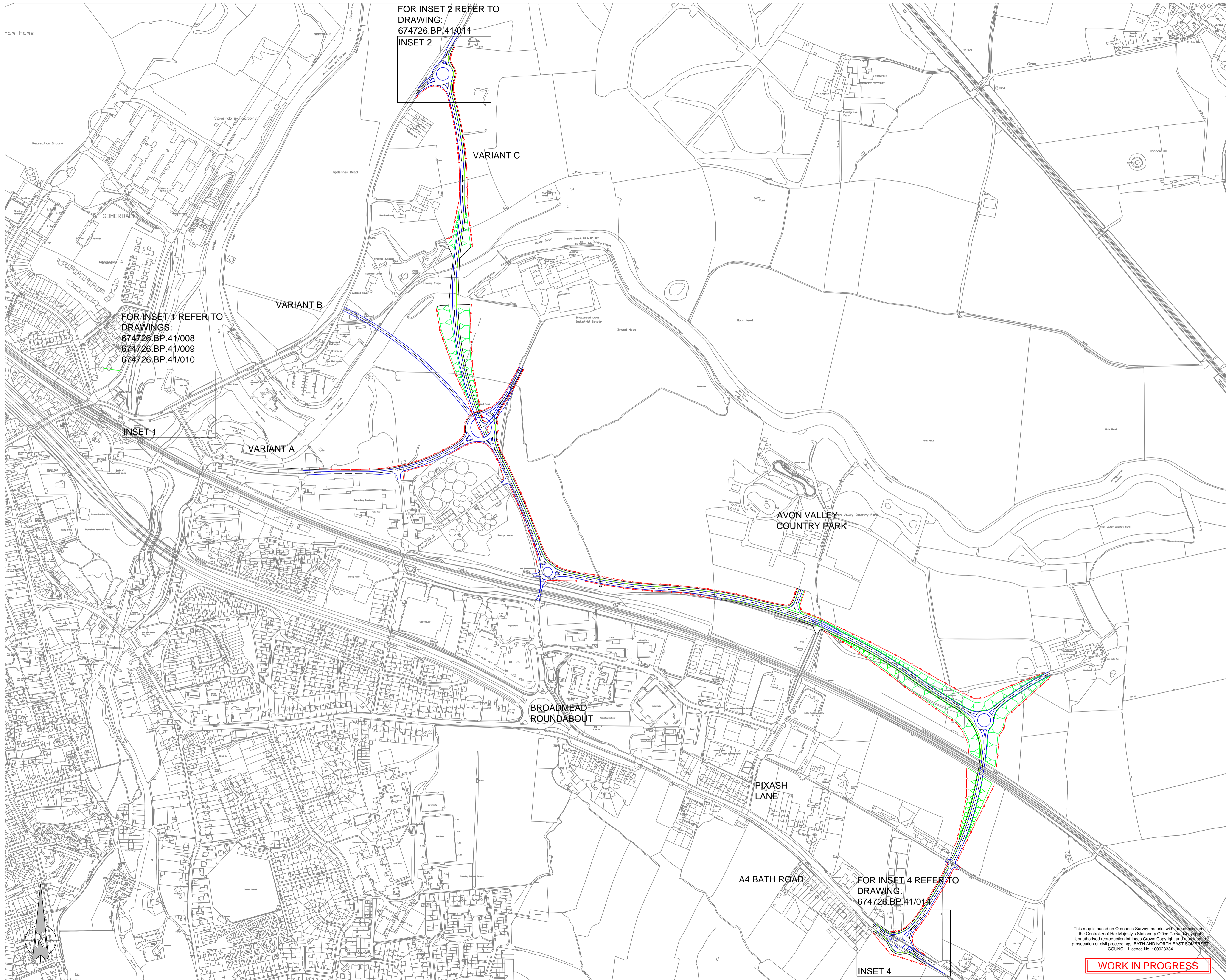

FOR INSET 2 REFER TO
DRAWING:
674726.BP.41/011
INSET 2

FOR INSET 1 REFER TO
DRAWINGS:
674726.BP.41/008
674726.BP.41/009
674726.BP.41/010

FOR INSET 4 REFER TO
DRAWING:
674726.BP.41/014

This map is based on Ordnance Survey material with the permission of the Controller of Her Majesty's Stationery Office. Copyright and any other rights in the map are reserved. Bath and North East Somerset Council. Licence No. 100023334

WORK IN PROGRESS

Rev	By	Chkd	Apprvd	Date	Description

WEST OF ENGLAND
Combined Authority

ch2m
1 The Square Temple Quay Bristol BS1 6DG
Tel +44 (0) 117 910 2580 Fax +44 (0) 117 910 2581
www.ch2m.com

Project
FEASIBILITY STUDY

Drawing
**WP2
OPTION 3 VARIANTS
KEY PLAN**

Drawn by: AH	Date: 22.01.18
Checked by: AS	Date:
Approved by: DL	Date:

Drawing No.	Revision
674726.BP.41/003	-

Drawing Scale: NTS @ A1