

ISO A1 594mm x 841mm Approved: LD Checked: LD Designer: AS Project Management Initials: Project Management Initials: WIP02\_SHEETS\6068625-ACM-04-LL\_ETRO-SHT-0100-002-C03.DWG  
 Filename: I:\AECOM\NET\COM\LS\EME\Bristol\_UKBR2\DCS\PROJECTS\6068625-ACM-04-LL\_ETRO-SHT-0100-002-C03.DWG  
 Printed on 100% Post-Consumer Recycled Content Paper

**KEY**

- EXISTING FEATURES TO REMAIN**
- UTILITY COVER (APPROX. LOCATION)
  - BOLLARD
  - THERMOPLASTIC ROAD MARKINGS
- EXISTING FEATURES TO RELOCATE**
- SIGN PLATE
- PROPOSED FEATURES**
- PROVIDE AND LAY REDIKERB SURFACE KERBING - HALF BATTERED PROFILE (REFER TO 1100 SERIES FOR DETAILS)
  - DROPPED KERBS - EXISTING KERB TO BE RE-LAID AS DROPPED KERB (REFER TO 1100 SERIES FOR DETAILS)

**FOR CONSTRUCTION**

ISSUE/REVISION		
I/R	DATE	DESCRIPTION
C05	21/06/2024	REMOVED TEMP TACTILES
C04	14/06/2024	REVISED ROAD MARKING
C01	22/02/2024	ISSUE FOR CONSTRUCTION

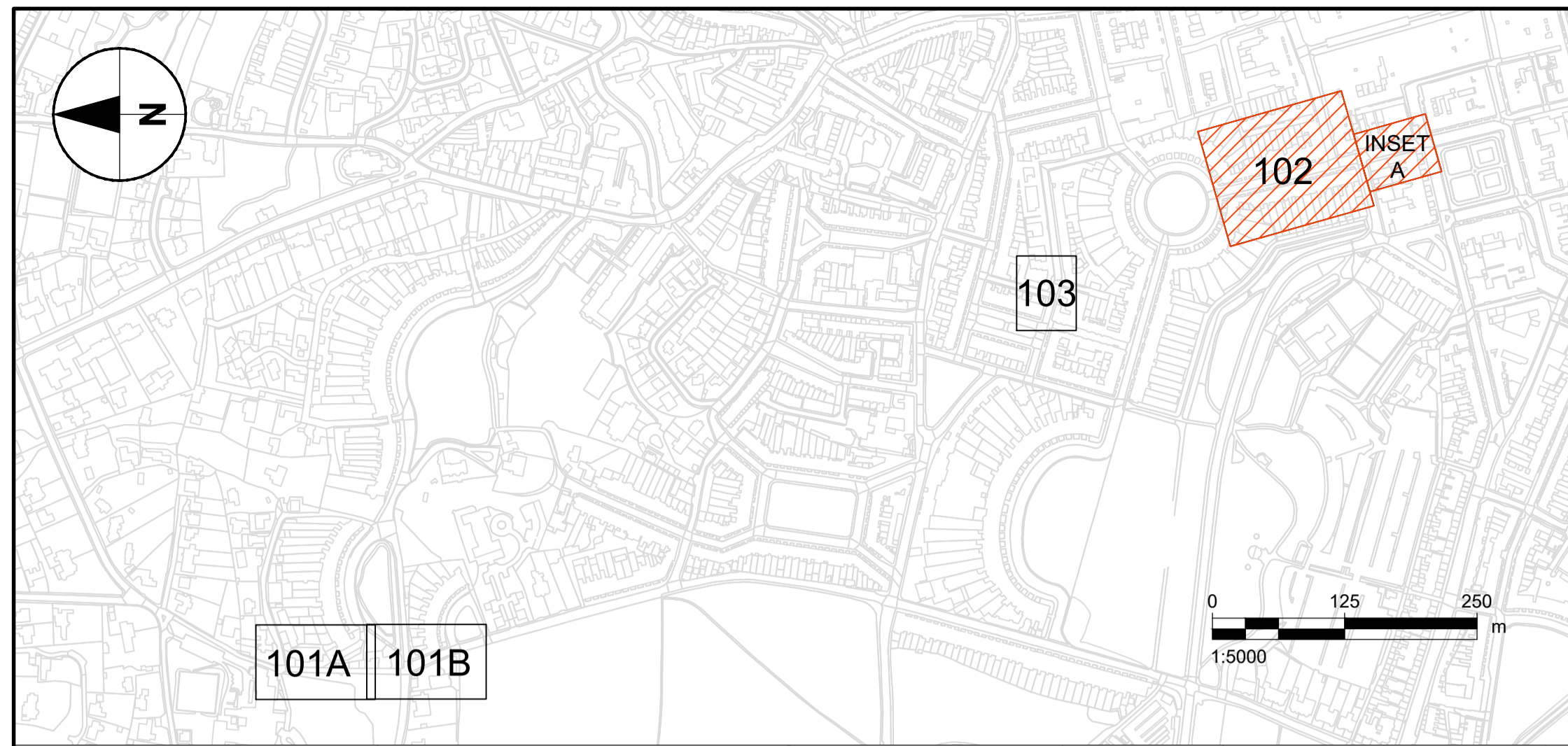
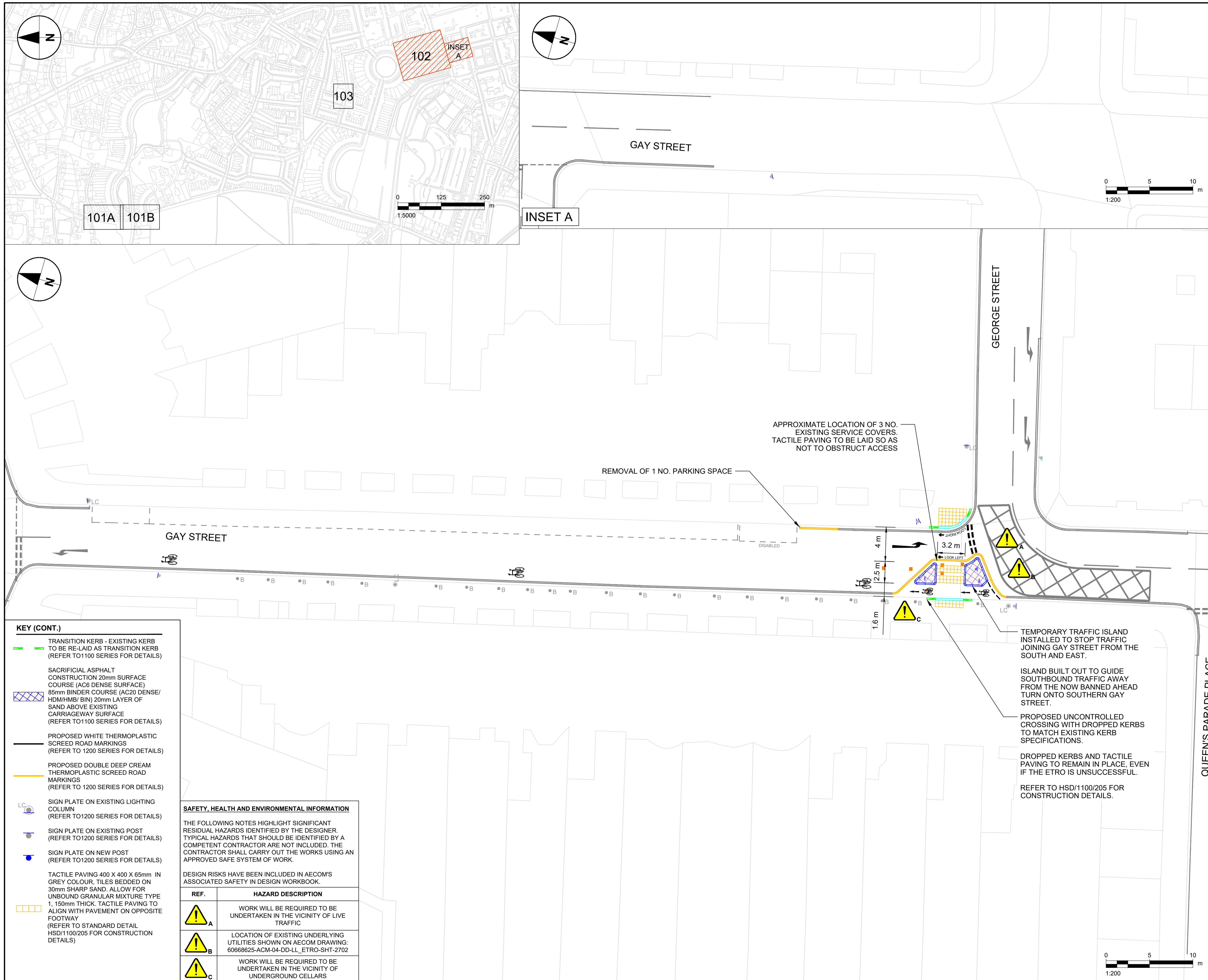

**KEY (CONT.)**

- TRANSITION KERB - EXISTING KERB TO BE RE-LAID AS TRANSITION KERB (REFER TO 1100 SERIES FOR DETAILS)
- SACRIFICIAL ASPHALT CONSTRUCTION 20mm SURFACE COURSE (AC6 DENSE SURFACE) 85mm BINDER COURSE (AC20 DENSE/HDM/HMB/ BIN) 20mm LAYER OF SAND ABOVE EXISTING CARRIAGEWAY SURFACE (REFER TO 1100 SERIES FOR DETAILS)
- PROPOSED WHITE THERMOPLASTIC SCREED ROAD MARKINGS (REFER TO 1200 SERIES FOR DETAILS)
- PROPOSED DOUBLE DEEP CREAM THERMOPLASTIC SCREED ROAD MARKINGS (REFER TO 1200 SERIES FOR DETAILS)
- SIGN PLATE ON EXISTING LIGHTING COLUMN (REFER TO 1200 SERIES FOR DETAILS)
- SIGN PLATE ON EXISTING POST (REFER TO 1200 SERIES FOR DETAILS)
- SIGN PLATE ON NEW POST (REFER TO 1200 SERIES FOR DETAILS)
- TACTILE PAVING 400 X 400 X 65mm IN GREY COLOUR, TILES BEDDED ON 30mm SHARP SAND. ALLOW FOR UNBOUND GRANULAR MIXTURE TYPE 1, 150mm THICK. TACTILE PAVING TO ALIGN WITH PAVEMENT ON OPPOSITE FOOTWAY (REFER TO STANDARD DETAIL HSD/1100/205 FOR CONSTRUCTION DETAILS)

**SAFETY, HEALTH AND ENVIRONMENTAL INFORMATION**

THE FOLLOWING NOTES HIGHLIGHT SIGNIFICANT RESIDUAL HAZARDS IDENTIFIED BY THE DESIGNER. TYPICAL HAZARDS THAT SHOULD BE IDENTIFIED BY A COMPETENT CONTRACTOR ARE NOT INCLUDED. THE CONTRACTOR SHALL CARRY OUT THE WORKS USING AN APPROVED SAFE SYSTEM OF WORK.

DESIGN RISKS HAVE BEEN INCLUDED IN AECOM'S ASSOCIATED SAFETY IN DESIGN WORKBOOK.

REF.	HAZARD DESCRIPTION
A	WORK WILL BE REQUIRED TO BE UNDERTAKEN IN THE VICINITY OF LIVE TRAFFIC
B	LOCATION OF EXISTING UNDERLYING UTILITIES SHOWN ON AECOM DRAWING: 6068625-ACM-04-DD-LL_ETRO-SHT-2702
C	WORK WILL BE REQUIRED TO BE UNDERTAKEN IN THE VICINITY OF UNDERGROUND CELLARS